



**FAMACY GROUP**





## Company Profile

Famacy Group is one of the biggest pharmaceutical glass development, manufacturing and marketing company in China. Founded in 1988, Famacy Group possess three professional production sites located at ChangZhou, ChengDu and Weiyuan, including over 50,000 square meters of workshop and 1200 employees.

By taking control of 5 glass furnaces and over 250 production lines, Famacy Group has an annual production capacity of 2 billion glass vials, 3.5 billion Ampoules, 50 million cartridges, and 40,000 tons of pharmaceutical glass tubing.

Famacy Group has successfully passed ISO9001:2015, and the registration of DMF by US FDA.

### Product's Raw Materials:

- 3.3 glass tubing
- 5.0 glass tubing

### Glass Type:

- USP type I

By applying the ISO and FDA quality and document control system, our products are widely used as packaging for pharmaceutical, ophthalmology, vaccines, bio-engineering, hydro-acupuncture products and lyophilization & powder injection solutions.

We have built steady business relationship with over 100 excellent domestic pharmaceutical enterprises. Over the past years, our products have been exported to more than 10 countries.

Famacy Group is looking forward to building stable business partnership with our clients all over the world.



# Content



01

Glass Tubing



05

Glass Ampoules



07

Glass Vial



09

RTU Vial



11

Cartridge



13

Pre-filled syringe



15

Moulded Glass Vial

# Glass Tubing Series

Neutral Borosilicate Glass Tubing

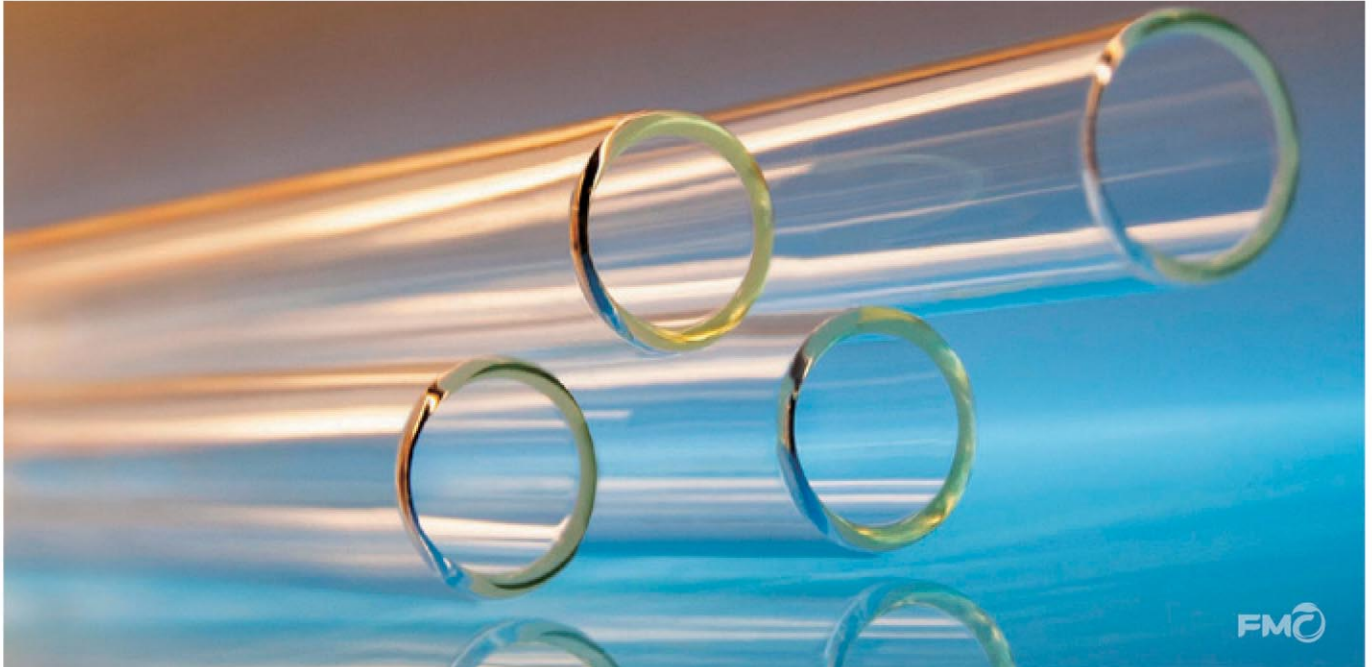

## EXCELLENT RAW MATERIAL

FAMACY has its own glass tube manufacturing base in Sichuan Province. Meanwhile, we import glass tubes from SCHOTT, CORNING and NEG, to satisfy our clients with their different requirements.

## PACKAGING MATERIAL

Heat shrinking packaging, avoid pollution and friction.  
Imported raw material: diameter 10-40mm.  
Good storage condition, prevent pollution.

### FURNACE





- Glass type I (compliant to Pharm.Eur./USP/JP), Thermal linear expansion is 5.0.
- Diameters from 7mm to 45mm.
- Automatic 100% inspection.
- Automatic packaging system.

## **In-Line quality inspection**

### **1. Cosmetic inspection system**

- 100% cosmetic inspection on all lines
- Camera and laser inspection
- Circular coverage: 100%
- Defect types: airlines, Knots & Stones, etc.

### **2. Dimensional inspection for outer and inner diameter**

- 100% inspection on all lines with automated reject
- Laser inspection for OD
- Camera inspection for ID and wall thickness

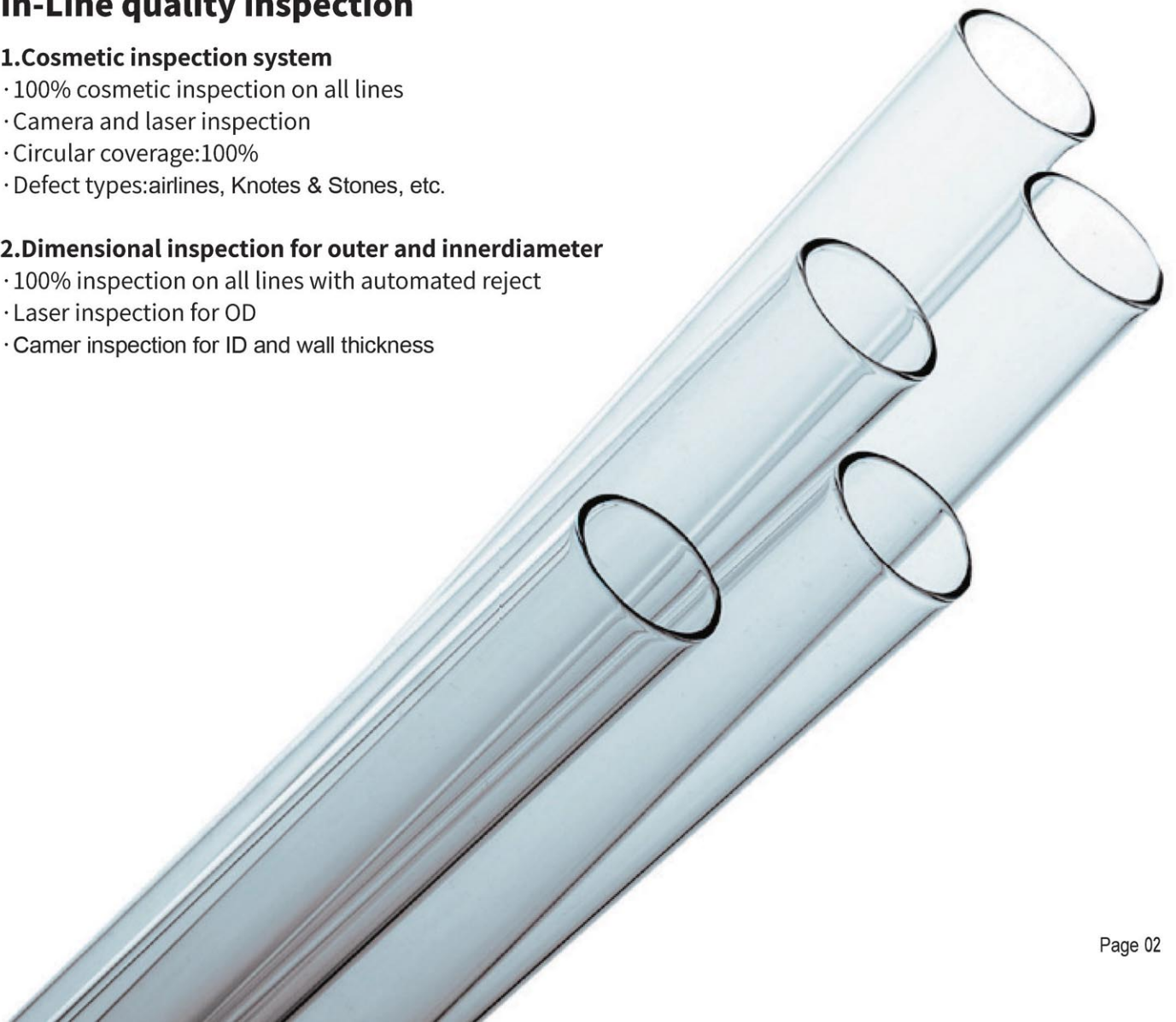



### Glass tubing for ampoules spec and size (UNIT:mm)

O.D	W.T	Length
10.75±0.15	0.5±0.03	1500
12.75±0.15	0.5±0.03	1500
14.75±0.15	0.55±0.03	1500
17.75±0.2	0.6±0.04	1500
22.5 ± 0.25	0.7±0.04	1500

Can Customerize accordingly





- International advanced production equipments and technologies.
- Diameter online laser measurement, fine cutting end, high pressure particle removing, thermo shrunk packaging, pallet transportation.

### Glass tubing for vials spec and size (UNIT:mm)

O.D	W.T	Length
16±0.15	1±0.04	1500
22±0.20	1±0.04	1500
24±0.20	1±0.04	1500
30±0.25	1.2±0.05	1500

Can Customize accordingly



# Pharmaceutical Packaging Material series

## Glass Ampoules

- Type I glass.
- Clear and amber glass ampoules.
- Brimful capacities from 1 to 30ml.
- ISO form B, C and D as well as customized special shapes.
- OPC (One Point Cut), CBR (Color Break Ring) and SCR (Score Ring) with optimized opening forces.
- Up to three colored coded identification rings or customized ceramic printing.
- PP shrinkable film packaging.





### Form B

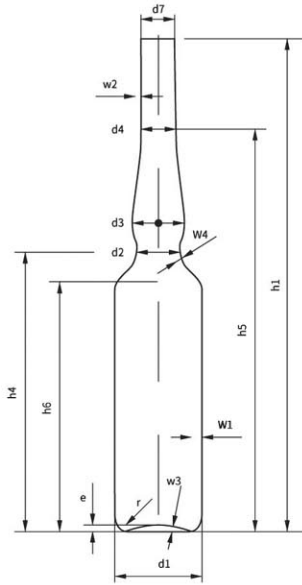

### Form C

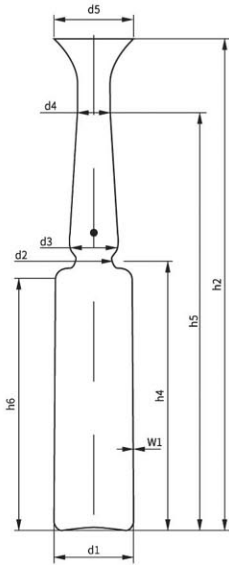

### Form D

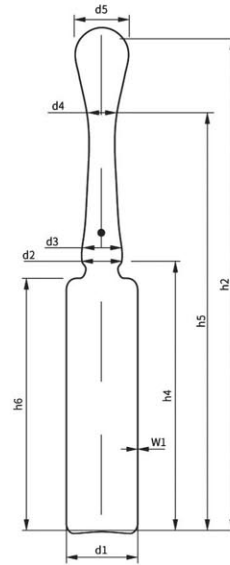

## Ampoules specification (UNIT:mm) ISO 9187-1:2000

Size	Outer diameter									Total height	
	Boby OD		Constriction ID	Bulb ID		Stem		Funnel		B	C
	d1		d2	d3		d4		d5		h1	h2
		Tolerance	±0.5		Tolerance		Tolerance		Tolerance	±1.0	±1.0
1	10.75	±0.15	6.5	8.5	±0.5	6.0	±0.35	9.0	±0.8	60.0	67.0
2	10.75	±0.15	6.5	8.5	±0.5	6.0	±0.35	9.0	±0.8	72.0	79.0
3	12.75	±0.15	6.5	8.5	±0.5	6.0	±0.35	10.7	±0.8	75.0	82.0
5	14.75	±0.15	7.0	9.0	±0.5	7.0	±0.35	12.2	±1.0	83.0	90.0
10	17.75	±0.20	7.5	9.5	±0.5	7.1	±0.35	13.0	±1.0	102.0	109.0
20	22.50	±0.25	8.5	12.0	±1.0	7.8	±0.5	14.0	±1.0	113.0	120.0
25	22.50	±0.25	8.5	12.0	±1.0	7.8	±0.5	14.0	±1.0	128.0	135.0
30	22.50	±0.25	8.5	12.0	±1.0	7.8	±0.5	14.0	±1.0	143.0	150.0

Height			Bottom			Wall thickness							
Height up to constriction	Height up to ganging Point	Body height	Base radius	Concavity		Body thickness	Stem thickness	Bottom thickness	Constriction thickness		Eccentricity		
h4	h5	h6	r	e		w1	w2	w3	w4		t		
	Tolerance	±0.2	Min	±0.5		Tolerance	±0.05	Min		Tolerance			
25.5	±0.50	47.0	21.0	1.0	1.0	±0.5	0.5	±0.03	0.37	0.3	0.7	±0.1	0.6
37.5	±0.50	57.0	33.0	1.0			0.5	±0.03	0.37	0.3			0.6
39.5	±0.50	62.0	35.0	1.5			0.5	±0.03	0.37	0.3			0.8
46.5	±0.50	68.0	41.0	1.5			0.55	±0.03	0.4	0.4	0.7	±0.15	1.0
62.0	±1.0	87.0	55.0	2.0	1.25	±0.75	0.6	±0.04	0.47	0.4	0.8	±0.15	1.0
76.0	±1.0	100.0	65.0	2.5	1.5	±1.0	0.7	±0.04	0.5	0.5	1.0	±0.2	1.2
91.0	±1.0	115.0	80.0	2.5			0.7	±0.04	0.5	0.5			1.2
106.0	±1.0	130.0	95.0	2.5			0.7	±0.04	0.5	0.5			1.2

# Pharmaceutical Packaging Material series

## Neutral Borosilicate

### Glass Vial ( USP type I )

I Lyophilized vial



II Insulin vial



III Injection vial



IV Coated vials



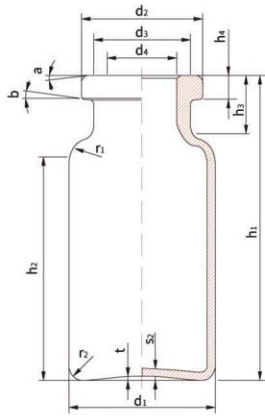

**FORM A**

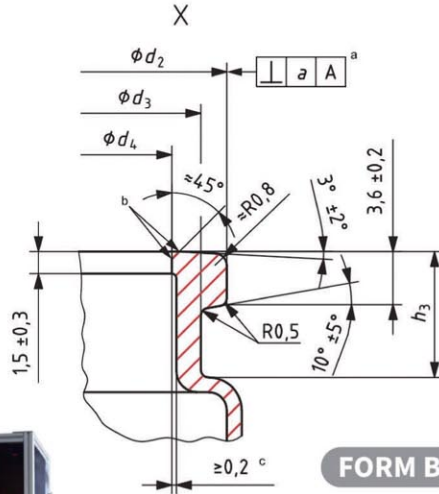
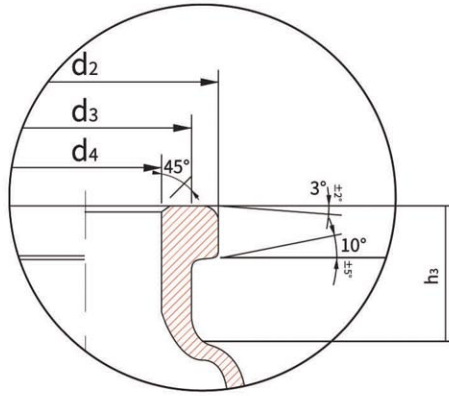

**FORM B**

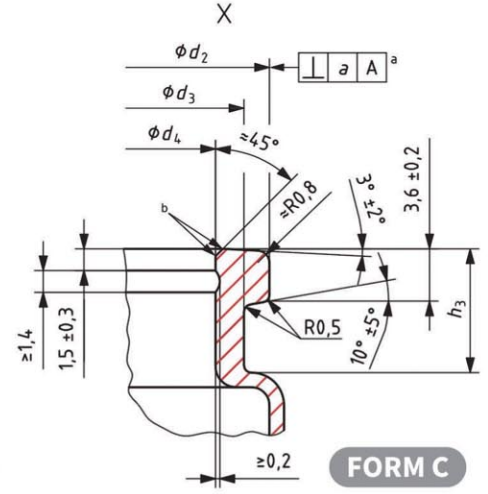

**FORM C**

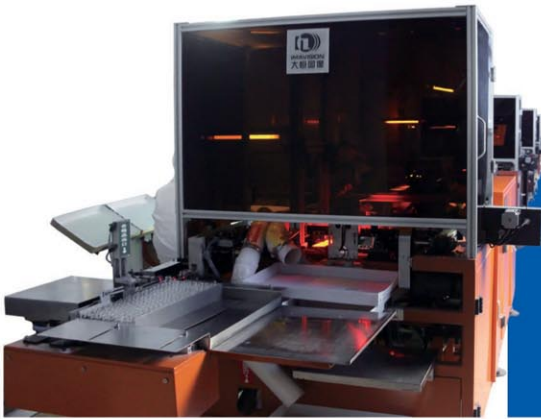

**Vials Specification (UNIT:mm) ISO 8362-1**

Size	Full volume		a	d1	d2	d3	d4	h1	h2	h3	r1	r2	s1	s2	t	wei- ght			
	Tolerance																Tolerance	+0.2 -0.3	Max
2R	4.0	±0.5	1.0	16.0	±0.15	13.0	10.5	7.0	35.0	±0.5	22.0	8.0	2.5	1.5	1.0	±0.04	0.6	0.7	5.0
4R	6.0	±0.5	1.0	16.0															45.0
6R	10.0	±0.5	1.2	22.0	±0.2	16.5	12.6	40.0	±0.5	26.0	8.5	±0.5	3.5	2.0	1.0	±0.04	0.7	0.7	8.3
8R	11.5	±0.5	1.2	22.0															45.0
10R	13.5	±1.0	1.2	24.0	±0.25	20.0	12.6	45.0	±0.7	30.0	9.0	4.0	1.2	±0.05	1.0	±0.05	1.0	1.0	10.2
15R	19.0	±1.0	1.2	24.0															60.0
20R	26.0	±1.5	1.5	30.0	±0.25	17.5	12.6	55.0	±0.7	35.0	10.0	±0.75	5.5	2.5	1.2	±0.05	1.0	1.0	17.4
25R	32.5	±1.5	1.5	30.0															65.0
30R	37.5	±1.5	1.5	30.0				75.0		55.0									22.7

# Ready To Use Vials

Pre-washed & Steriled

1

Pre-washed



2

Packed in double sterile bags

Vials in tray



Vials in nest & tub



# Type I Glass Tube for biological indicator

0.27mm  
wall thickness

Type I Hydrolytic Resistance  
Class S1 Acid Resistance  
Class A2 Alkali Resistance

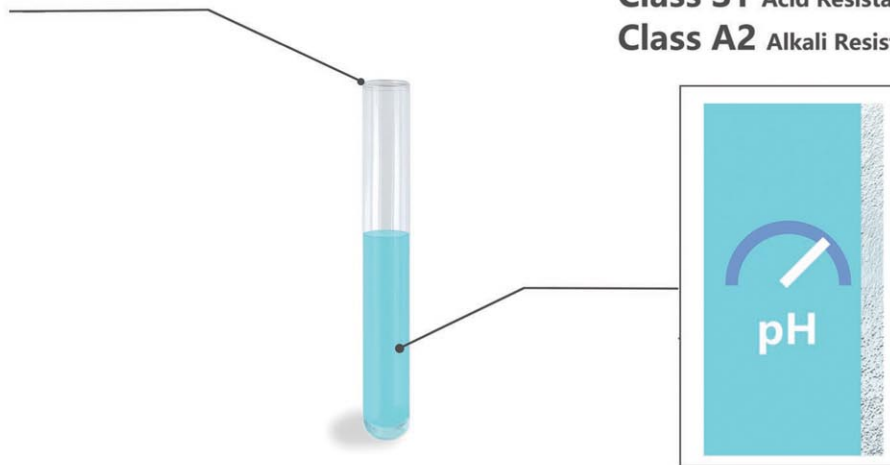

Biological indicator

# Pharmaceutical Packaging Material series

## I Cartridges & Injector, ISO 13926-1

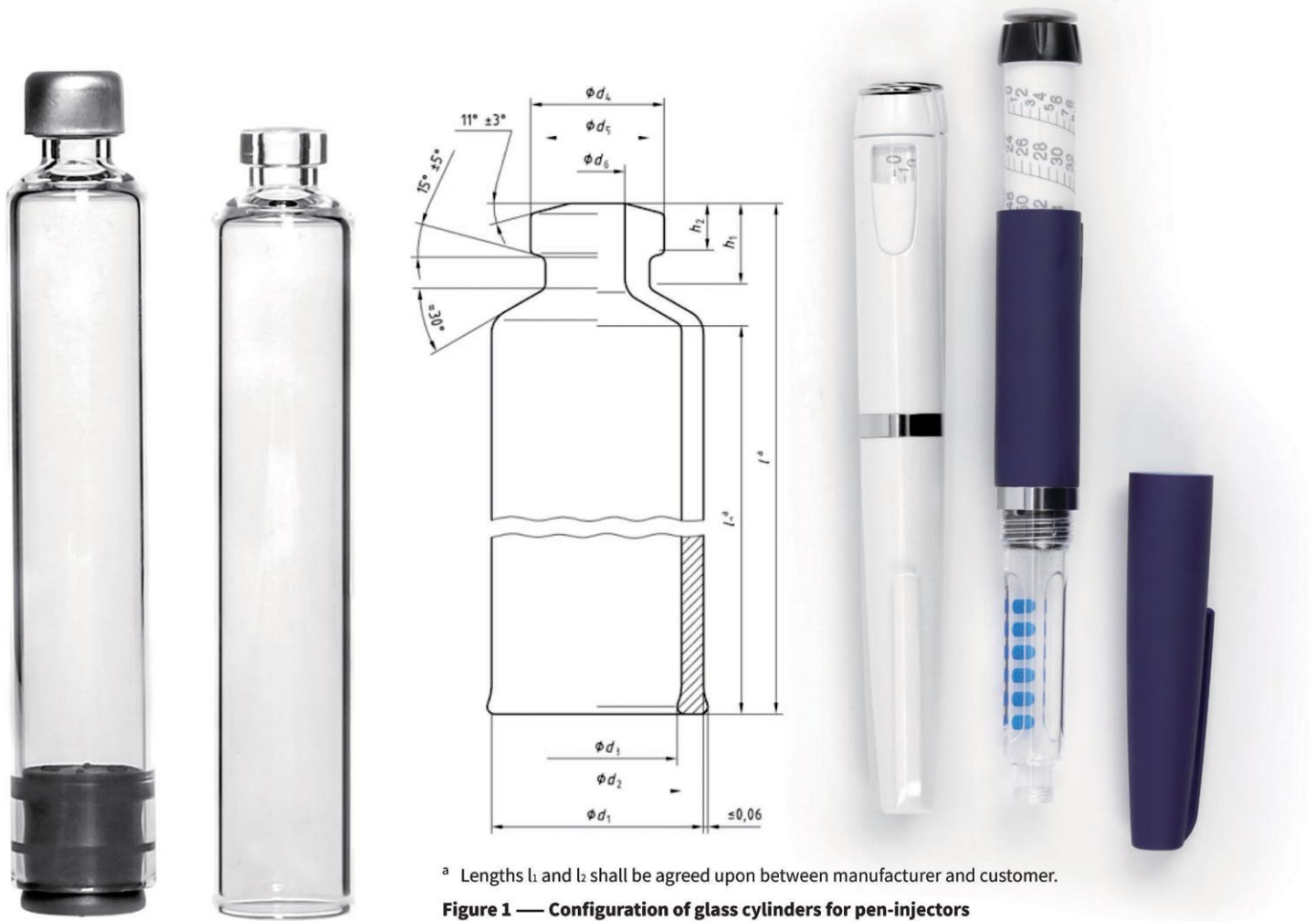

### Cartridge Specification

(UNIT:mm)

d1	tol.	d2	tol.	d3	d4	tol.	d5	tol.	d6	tol.	h1	tol.	h2	tol.
	±		±	min.		±		±		±		±		±
8.65	0.1	6.85	0.1	6.55	7.15	0.2	5.5	0.35	3.15	0.2	5.0	0.20	2.9	0.1
10.85	0.1	8.65	0.1	8.35	7.15	0.2	5.5	0.35	3.15	0.2	5.0	0.20	2.9	0.1
10.95	0.15	9.25	0.1	8.95	7.15	0.2	5.5	0.35	3.15	0.2	5.0	0.20	2.9	0.1
11.60	0.15	9.65	0.1	9.35	7.15	0.2	5.5	0.35	3.15	0.2	5.0	0.20	2.9	0.1
14.00	0.15	12.00	0.15	11.65	9.5	0.2	7.6	0.35	4.5	0.2	5.0	0.50	2.9	0.15
14.45	0.15	11.85	0.15	11.50	9.5	0.2	7.6	0.35	4.5	0.2	5.0	0.50	2.9	0.15
18.25	0.15	16.05	0.15	15.50	9.5	0.2	7.6	0.35	4.5	0.2	5.0	0.50	2.9	0.15

## II Cartridges, ISO 11040-1



Dimensions in millimetres

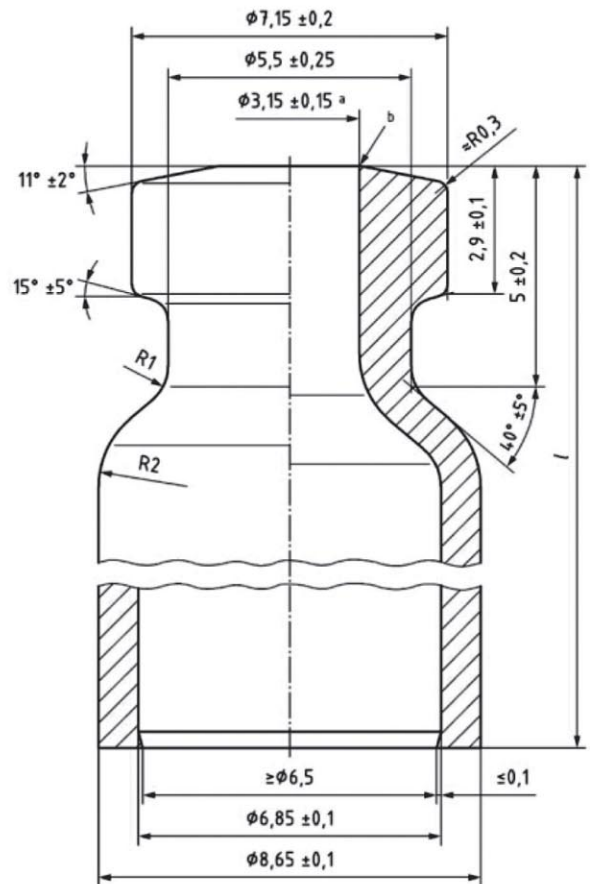

Technical Data for Cartridge 1.8ml

Technical Data for Cartridge 1.8ml			
	Explanations	Average(mm)	Tolerance
Diameter	Body	8.65	$\pm 0.1$
	Inside body	6.85	$\pm 0.1$
	Cylinder entrance	$\geq 6.5$	
	Mouth	7.15	$\pm 0.2$
	Inside mouth	3.15	$\pm 0.15$
	Neck	5.5	0.25
Height	Overall	62	$\pm 0.3$
	Lip	2.9	$\pm 0.1$
	Lower end neck to top	5	$\pm 0.2$

# Pharmaceutical Packaging Material series

## Pre-filled syringe





# Nest sterilized package for prefilled syringes, cartridges and vials



I









II



# USP Type I, II & III Moulded Glass Vial for injection



						
7ml	7	9	13.0	ISO/SFDA	40.8	22.1
8ml	8	10	16.0	ISO/SFDA	46.8	23.0
10ml	10	15	21.0	ISO/SFDA	53.8	25.4
15ml	15	17	24.0	ISO/SFDA	53.0	26.5
20ml	20	26	29.0	ISO/SFDA	58.0	32.0
30ml	30	38	35.0	ISO/SFDA	62.8	36.0
50ml	50	60	50.0	ISO/SFDA	73.0	42.5
100ml	100	119	89.0	ISO/SFDA	94.5	51.6

Series complies with the norms ISO8362-4 and SFDA YBB00312002

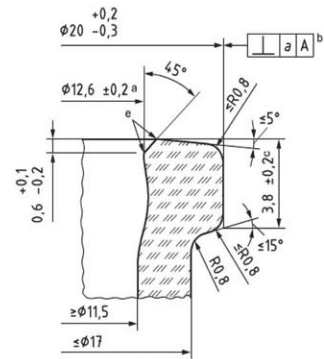

# Screw mouth moulded Vials



60ml	60	69	73	G.P.I 33-400	75.5	44.5
75ml	75	86	84	G.P.I 38-400	82.5	45.3
100ml	100	114	95	G.P.I 38-400	87.5	50
120ml	120	135	108	G.P.I 38-400	95	52.8
150ml	150	170	122	G.P.I 45-400	100	56
200ml	200	226	151	G.P.I 45-400	109.5	61.4
250ml	250	274	170	G.P.I 45-400	117.5	65.3



10ml	10	14.8	23	PP18	58	25.4
30ml	30	36	38	PP24	74.1	33
50ml	60	54	59	PP24	82.1	39.6
80ml	80	90.5	62	PP24	91.5	46.4
100ml	100	113	92	PP24	99.8	49
150ml	150	165	103	PP24	109.2	56
200ml	200	216	133	PP24	129.9	57.2

PP Box & shrink wrap packaging



# Company Culture

**1**

**Customer always  
comes first**

**2**

**We cherish  
hard working**

**3**

**We devote into  
long term  
hard working**

# Farmacy Group Orientation

We provide the whole service of pharmaceutical glass project.

· Provide ampoules, vials, cosmetic packaging, cartridges and Pre-filled syringe so on.

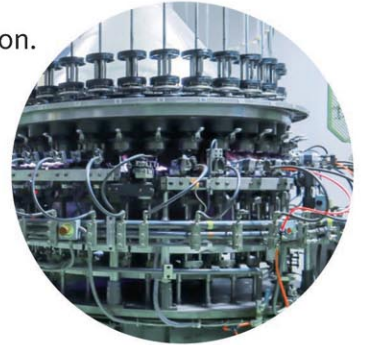



## The global recruitment of agency

Welcome to join us  
as our agents  
(distributors)  
or commission agents  
from all over the world.

**FAMACY GLASS**

## Sales Network

We have built steady business relationship with more than 30 pharmaceutical companies, and export products to many countries such as **JAPAN, KOREA, TURKEY, RUSSIA, UZBEKISTAN, INDONESIA, INDIA, SOUTH AMERICA** and so on.



**Add 1:** 3 Wujin Road, Changzhou City, Jiangsu Province, China

**Add 2:** Qionglai Industrial Zone, Chengdu City, Sichuan Province, China

**Add 3:** Weiyuan Industrial Zone, Neijiang City, Sichuan Province, China

**Tel:** (86)-519-85554112 (86)-18915801688

**Fax:** (86)-519-85809659

**E-mail:** [info@famacy.com](mailto:info@famacy.com)

**Web:** [www.famacy.com](http://www.famacy.com)