

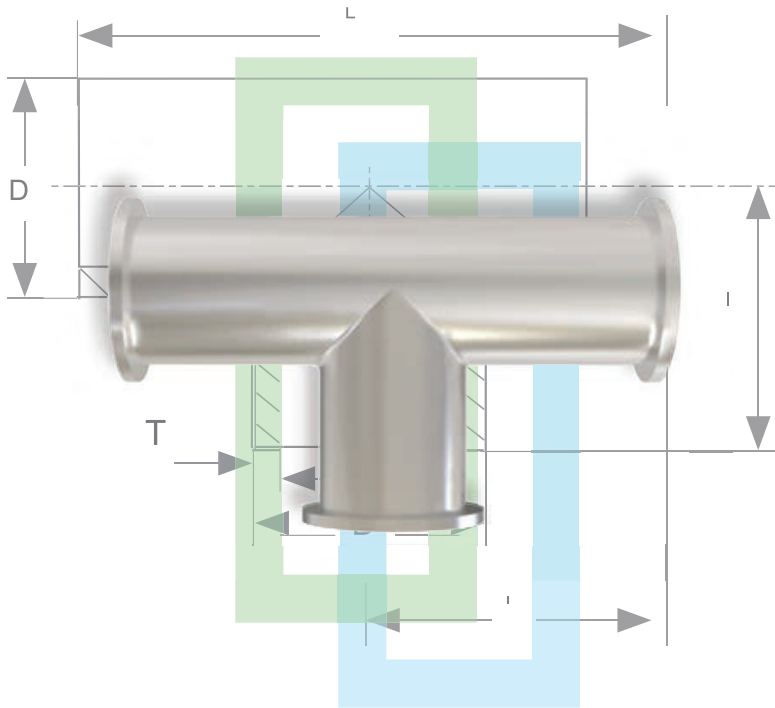

rensa
Positively Smooth



Cert No. BPE-183



ASME-BPE

SFO / SF1 / SF2 / SF3 / SF4 / SF5 / SF6

1.4307 (304L), 1.4404 & 1.4435 (316L)

Tubes

Bends

Tee

Reducers

Ferrule

Clamps

End caps

PRECISION ENGINEERED

TUBES & FITTINGS

Surface perfected, dimensionally precise
ASME - BPE Tubes & Fittings

INDEX

3	ABOUT US	19	INSTRUMENT TEE (TUBE WELD)
4	WHY BIOPURE	19	INSTRUMENT TEE (HYGIENIC CLAMP JOINT)
5	CLEANING & PACKAGING	19	STANDARD OUTLET TEE (TUBE WELD & HYGIENIC CLAMP JOINT)
6	DIMENSIONAL TOLERANCES	20	STANDARD OUTLET REDUCING TEE (TUBE WELD & HYGIENIC CLAMP JOINT)
7	SURFACE FINISH	21	CONCENTRIC REDUCER (TUBE WELD)
8	ELECTROPOLISHING EDGE	21	ECCENTRIC REDUCER (TUBE WELD)
9	ORDERING INFORMATION	22	CONCENTRIC REDUCER (TUBE WELD - HYGIENIC CLAMP JOINT)
9	TUBES SPECIFICATIONS	22	ECCENTRIC REDUCER (TUBE WELD - HYGIENIC CLAMP JOINT)
10	90° BEND (TUBE WELD)	23	CONCENTRIC REDUCER (HYGIENIC CLAMP JOINT)
10	90° BEND (TUBE WELD HYGIENIC CLAMP JOINT)	23	ECCENTRIC REDUCER (HYGIENIC CLAMP JOINT)
10	90° BEND (HYGIENIC CLAMP JOINT)	24	FERRULE (TUBE WELD)
11	45° BEND (TUBE WELD)	24	FERRULE (TUBE WELD)
11	45° BEND (TUBE WELD HYGIENIC CLAMP JOINT)	24	FERRULE (TUBE WELD)
11	45° BEND (HYGIENIC CLAMP JOINT)	25	CAP (TUBE WELD)
12	180° RETURN BEND (TUBE WELD)	25	SOLID END CAP (HYGIENIC CLAMP JOINT)
12	180° RETURN BEND (HYGIENIC CLAMP JOINT)		
12	STRAIGHT TEE (TUBE WELD)		
13	STRAIGHT CROSS (TUBE WELD)		
13	SHORT OUTLET TEE (TUBE WELD: CLAMP JOINT)		
13	SHORT OUTLET RUN TEE (HYGIENIC MECHANICAL JOINT)		
14	STRAIGHT TEE (HYGIENIC CLAMP JOINT)		
14	STRAIGHT CROSS (HYGIENIC CLAMP JOINT)		
14	SHORT OUTLET TEE (HYGIENIC CLAMP JOINT)		
15	REDUCING TEE (TUBE WELD)		
16	SHORT OUTLET REDUCING TEE (TUBE WELD)		
17	REDUCING TEE (TUBE WELD & HYGIENIC CLAMP JOINT)		
18	SHORT OUTLET REDUCING TEE (HYGIENIC CLAMP JOINT)		

About Us



Biopure - INDIA'S FIRST ASME - BPE CERTIFIED RANGE OF PRODUCTS FOR THE BIO-PHARMACEUTICAL INDUSTRY

Rahul Ferroment & Engineering Pvt Ltd, under the brand name of rensa, manufactures hygienic & ultrahigh purity stainless steel tubular products at it's manufacturing facility in Gujarat, India.

17+ Years of manufacturing experience clubbed with fully automated European technology production lines

Our Tubes and Fittings, manufactured with attention to detail are crafted to perfection under stringent quality control standards. This thorough approach ensures that we manufacture only the finest grade of stainless steel tubes and fittings, catering to critical applications in Pharma, Bio-Pharmaceuticals, Healthcare and Cosmetics sectors.

INTEGRATED FACILITY	PRODUCTION CAPACITY	
AREA	TUBES	FITTINGS
20,000 ^{M²}	1,50,000 ^{MTRS}	50,000 ^{No's}



EXPERIENCE
THAT CULTIVATES TRUST

Biopure Elevates Industry Standards, serving from India

Having proven our product supremacy for more than a decade and as industry advocates from India, we raise the bar for purity, performance, and sustain ability, inspiring a global transformation. With **Biopure**, innovation is at the core of everything we do. We constantly push boundaries to deliver products that not only meet but exceed expectations. By choosing **Biopure** you become part of a movement that benefits the user - both technically and logistically, as we're strategically located in India to serve globally. Embrace the future with **Biopure** the true game-changer for tube and fittings.

Contact us today and take the first step towards elevating industry standards.



Assured surface finish

WHY CHOOSE BIO-PURE?

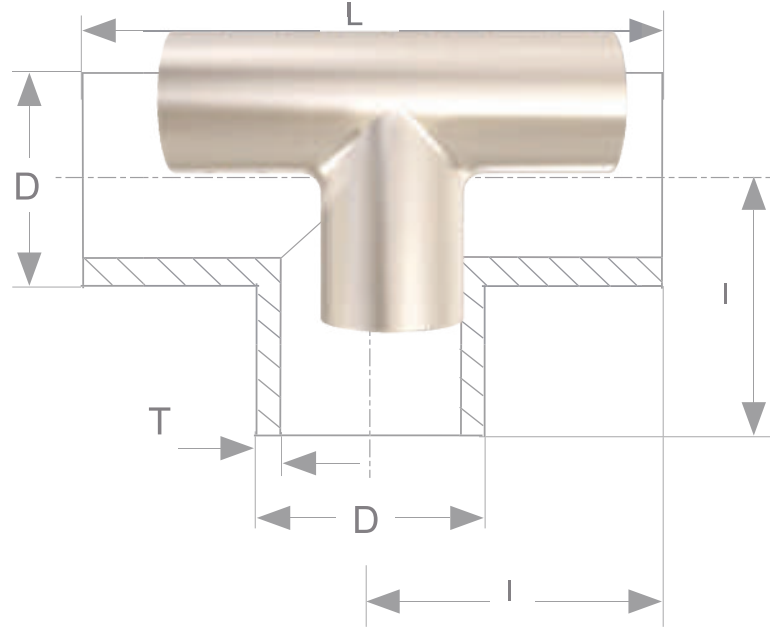

FULL TRACEABILITY

Biopure comes with full traceability ensuring transparency and reliability throughout the manufacturing process. Unique batch and serial numbers allow complete product history tracking, guaranteeing compliance, quality and peace of mind for critical applications. Trust excellence with Biopure Traceable ASME-BPE products

ASSURED QUALITY & CLEAN ABILITY

Adhering to ASME-BPE standards is our commitment. Each Bio-pure Product is passivated in accordance with ASME - BPE standards that guarantee optimal cleanliness for critical applications.

EFFORTLESS PROCUREMENT

Small Quantities accepted, Short Lead Times, Ex-Stock Availability, and Timely Delivery for all your SF4 and SF1 product needs.

ENVIRONMENT FRIENDLY PROCESS

We take environmental responsibility seriously. Our manufacturing processes are designed to be environmentally friendly, reducing our carbon footprint.

BIOPURE EDGE
GET THE ADVANTAGE



Cleaning & Packaging

PRODUCT

Stainless Steel Tubes & fittings complying with ASME BPE standards.

SIZE

Stainless Steel Tubes & Fittings are available in sizes ¼ “-6” O.D. Tube size.

MATERIALS

Fittings are fabricated in special grade 316L Stainless Steel with sulfur content of 0.005-0.017% achieving superior repeatability for automatic orbital welding process.

✓ ELECTRO-POLISHING EDGE WITH BIO-PURE

Rense takes immense pride in presenting our premium range of pharmaceutical products **Biopure**, our premium line of stainless steel tubes and fittings engineered to not only meet but surpass the highly specialized surface finishing requirements of the BPE industry, precisely outlined in the ASME BPE 2022 standards. The Sf1 - Sf3 and Sf4- Sf6 (EP) products exhibit properties that challenge the best-in-class.

✓ CLEANING

Biopure tubular products undergo multiple-step cleaning process, ensuring pristine surfaces both inside and out with consistent repeatability.

✓ INSPECTION PROCEDURE

All fittings produced by **Biopure** production are 100% visually inspected for any surface finish Irregularities. All dimensional characteristics are inspected for tolerances listed in parts DT-4-1 to DT-4.1.5-2 in the ASME BPE specification.

✓ PACKAGING & LABELING

Each fitting is capped, bagged and labeled in full compliance with the ASME BPE standard.

✓ DOCUMENTATION

Full material test reports are supplied with the finished products and are available on our website.

✓ PRODUCT INFORMATION

All our products are permanently Laser marked to show the following:

- a. Heat number/code traceable to material test report for each product contact surface component
- b. Material type
- c. Manufacturer's name, logo, & trademark
- d. Product contact surface designation
- e. ASME-BPE mark

Dimensional tolerances

DIMENSION TOLERANCE

Dimensional tolerance as specified in ASME-BPE Part DT-3-1

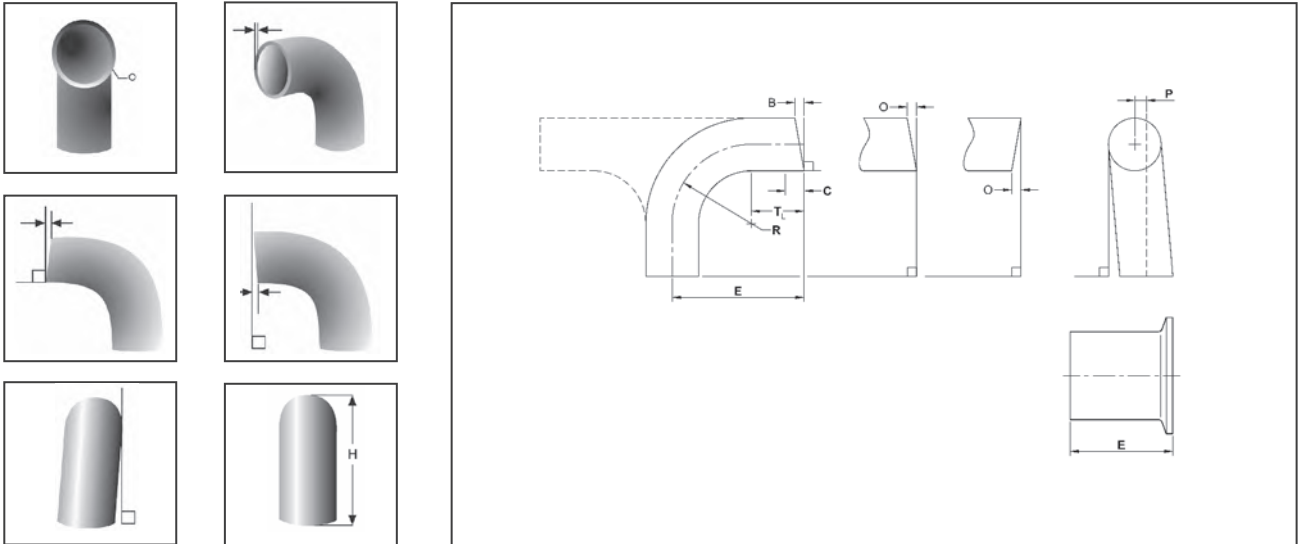

Table DT-3-3
Final Tolerances for Electro-polished fittings and
process components, excluding tube

Nominal Size, in.	Wall Thickness	
	in.	mm
1/4	+0.003/-0.006	+0.08/-0.15
3/8	+0.003/-0.006	+0.08/-0.15
1/2	+0.005/-0.010	+0.13/-0.25
3/4	+0.005/-0.010	+0.13/-0.25
1	+0.005/-0.010	+0.13/-0.25
1 1/2	+0.005/-0.010	+0.13/-0.25
2	+0.005/-0.010	+0.13/-0.25
2 1/2	+0.005/-0.010	+0.13/-0.25
3	+0.005/-0.010	+0.13/-0.25
4	+0.008/-0.012	+0.20/-0.30
6	+0.015/-0.017	+0.38/-0.43

General Notes:

- a. Tolerance on E end-to-end and center-to-end: 0.050 in. (1.27 mm)
- b. Tolerance for centerline radius (CLR) is $\pm 10\%$ of the nominal dimension

Surface Finish

Table SF, Table SF-2.4.1-1
Ra Readings for Metallic Process Contact Surfaces

Surface Designation	Mechanically Polished*	
	Ra Max.	
	μin.	μm.
SF0	No finish requirement	No finish requirement
SF1	20	0.51
SF2	25	0.64
SF3	30	0.76

Surface Designation	Electropolished	
	Ra Max.	
	μin.	μm.
SF4	15	0.38
SF5	20	0.51
SF6	25	0.64

- All Ra readings are to be in accordance with ASME B46.1
- All Ra readings are to be in across the lay wherever possible
- No single Ra reading shall exceed Ra Max in this table
- Other Ra readings available, not to exceed Ra value in this table

Note* : Or any other finishing method that meets the Ra max

ELEVATE

your bio-pharma experience with Bio-pure

THICKER OXIDE LAYER

All our surface finishing processes are specifically developed including proprietary electrolytes to create a higher passivation layer thus increasing corrosion resistance and minimizing rouging, providing enhanced reliability and efficiency in critical bio-pharma processes.

REDUCED BIO-FILM FORMATION & ADHESION

Every internal surface of Bio-Pure product surpasses a Roughness average (Ra) of the standard, effectively minimizing the product adhesion and bio-film formation, while maintaining the purity and integrity of your process.

ONE STOP SHOP

Fully integrated production value chain from raw material to finished products ensuring better process control supported by an experienced and dedicated team.

Electro-polishing edge with Biopure,

Rensa's electropolishing process is engineered to not only meet but surpass the stringent surface finishing requirements of the BPE industry, precisely outlined in the ASME BPE 2022 guidelines. Our SF4 - SF6 (EP) Biopure, products exhibit properties that challenge the best-in-class.

Electropolished products are the preferred choice for numerous application due to its outstanding surface smoothness, creating fewer sites for impurities. This translates to a purer product for the industry, with reduced risks of corrosion and bio-film formation.



BIO LOGICS ◇ VACCINES ◇ BIO-SIMILIARS ◇ CELL & GENE THERAPY ◇ BLOOD PRODUCTS ◇ DIAGNOSTIC AGENTS

The Biopure advantage

Electropolishing dramatically reduces micro roughness by dissolving metal ions faster at the exposed peaks, leading to lower Ra values, although most important is the smoother surface topography.

Electro-polishing, an advanced electrolytic process, employs a combination of electrical current and electrolytes to remove upper surface layers of the material. The process effectively dissolves peaks and other surface irregularities by non-impact methods exposing the pure crystalline structure of the material, resulting in a remarkably smooth surface. Our in-house electro-polishing facility has been developed and built by our technical team is overseen by our well-trained and experienced quality assurance team.

Our mechanical polishing process involves an abrasive material, mounted on a special polishing head, rotates continuously within the product, achieving the desired interior surface finish. A controlled surface layer is meticulously removed during the process. Before undergoing visual inspection and final surface measurement, the product undergoes thorough cleaning through our in-house specialist cleaning and passivation systems.

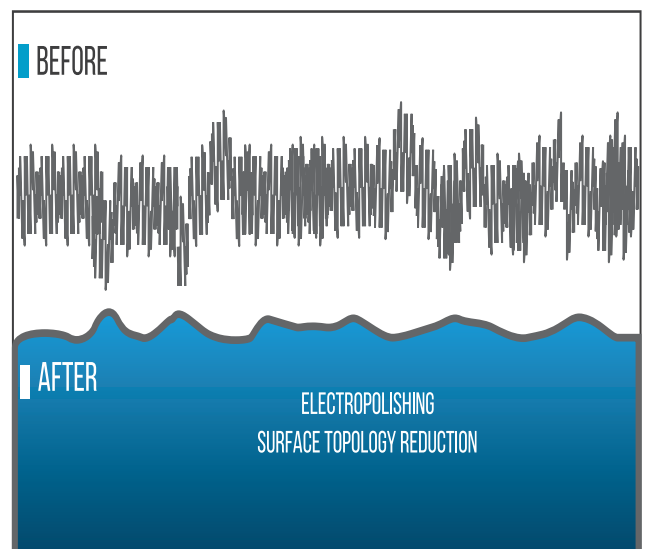

✓ DE-IONIZED WATER CLEANING

Biopure, tubes & fittings are cleaned with purified de-ionized water with low conductivity & high microbial purity

✓ CLEAN ROOM INSPECTION

The final quality inspection for all Biopure,, tubes & fittings are done in a Clean room environment

✓ PRODUCT PACKAGING

Biopure,, products are purged with Nitrogen and individually bagged & carefully packed for final shipment

Ordering Information

ITEM CODE / ORDER CODE

BP9BL0064SF44	BP9BL0064SF42	BP9BL0064SF14	BP9BL0064SF12
BP	ASME-BPE		
9BL	900 Bend long		
0064	OD Size 6.35mm		
SF4	Electro-polishing, Ra less than 0.38 micron		
SF1	Mechanical-polishing Ra less than 0.51 micron		
4	S31603-1.4404		
2	S30403-1.4307		
F	Clamp joint (Ferrule) - Joint in one end - as per ASME BPE date table		
FF	Clamp joint (Ferrule) - Joint in two ends - as per ASME BPE date table		
FFF	Clamp joint (Ferrule) - Joint in three ends - as per ASME BPE date table		
FFFF	Clamp joint (Ferrule) - Joint in all ends - as per ASME BPE date table		

TUBES SPECIFICATION

STANDARDS

- ASTM A269 / A270-S2
- ASME BPE

Table DT-4-1
Nominal O.D. Tubing Sizes

Nominal size, in	Tube O.D.			
	in	mm	in	mm
1/4	0.250	6.35	0.035	0.89
3/8	0.375	9.53	0.035	0.89
1/2	0.500	12.70	0.065	1.65
3/4	0.750	19.05	0.065	1.65
1	1.000	25.40	0.065	1.65
1 1/2	1.500	38.10	0.065	1.65
2	2.000	50.80	0.065	1.65
2 1/2	2.500	63.50	0.065	1.65
3	3.000	76.20	0.065	1.65
4	4.000	101.20	0.083	2.11
6	6.000	152.40	0.109	2.77

90°BEND (TUBE WELD)

Automatic Tube Weld:90° Bend –ASME BPE-2022 , DT-4.1.1-1

Order Code-SF4	Order Code-SF1	D, in.	D, mm	T, mm	A, mm
BP9BL0064SF44	BP9BL0064SF14	1/4"	6.35	0.89	66.68
BP9BL0095SF44	BP9BL0095SF14	3/8"	9.53	0.89	66.68
BP9BL0127SF44	BP9BL0127SF14	1/2"	12.7	1.65	76.20
BP9BL0191SF44	BP9BL0191SF14	3/4"	19.05	1.65	76.20
BP9BL0254SF44	BP9BL0254SF14	1"	25.4	1.65	76.20
BP9BL0381SF44	BP9BL0381SF14	1-1/2"	38.1	1.65	95.25
BP9BL0508SF44	BP9BL0508SF14	2"	50.8	1.65	120.65
BP9BL0635SF44	BP9BL0635SF14	2-1/2"	63.5	1.65	139.70
BP9BL0762SF44	BP9BL0762SF14	3"	76.2	1.65	158.75
BP9BL1016SF44	BP9BL1016SF14	4"	101.6	2.11	203.20
BP9BL1524SF44z	BP9BL1524SF14	6"	152.4	2.77	292.10

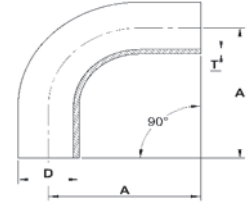

90°BEND (TUBE WELD HYGIENIC CLAMP JOINT)

Automatic Tube Weld: Hygienic Clamp Joint 90° Bend - ASME BPE - 2022, DT - 4.1.1-2

Order Code-SF4	Order Code-SF1	D, in.	D, mm	T, mm	A, mm	B, mm
BP9BL0064SF44F	BP9BL0064SF14F	1/4"	6.35	0.89	66.68	41,28
BP9BL0095SF44F	BP9BL0095SF14F	3/8"	9.53	0.89	66.68	41,26
BP9BL0127SF44F	BP9BL0127SF14F	1/2"	12.7	1.65	76.20	41.28
BP9BL0191SF44F	BP9BL0191SF14F	3/4"	19.05	1.65	76,20	41,28
BP9BL0254SF44F	BP9BL0254SF14F	1"	25.4	1.65	76.20	50,80
BP9BL0381SF44F	BP9BL0381SF14F	1-1/2"	38.1	1.65	95.25	69.85
BP9BL0508SF44F	BP9BL0508SF14F	2"	50.8	1.65	120.65	88.90
BP9BL0635SF44F	BP9BL0635SF14F	2-1/2"	63.5	1.65	139.70	107,95
BP9BL0762SF44F	BP9BL0762SF14F	3"	76.2	1.65	158,75	127.00
BP9BL1016SF44F	BP9BL1016SF14F	4"	101.6	2.11	203,20	168,28
BP9BL1524SF44F	BP9BL1524SF14F	6"	152.4	2.77	292.10	266.70

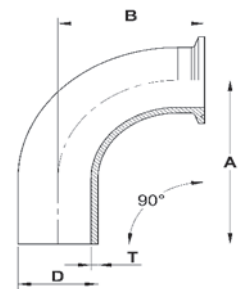

90°BEND (HYGIENIC CLAMP JOINT)

Hygienic Clamp Joint : 90° Bend –ASME BPE – 2022 , DT-4.1.1-3

Order Code-SF4	Order Code-SF1	D, in.	D, mm	T, mm	A, mm
BP9BL0064SF44FF	BP9BL0064SF14FF	1/4"	6.35	0.89	41.28
BP9BL0095SF44FF	BP9BL0095SF14FF	3/8"	9.53	0.89	41.28
BP9BL0127SF44FF	BP9BL0127SF14FF	1/2"	12.7	1.65	41.28
BP9BL0191SF44FF	BP9BL0191SF14FF	3/4"	19.05	1.65	41.28
BP9BL0254SF44FF	BP9BL0254SF14FF	1"	25.4	1.65	50.80
BP9BL0381SF44FF	BP9BL0381SF14FF	1-1/2"	38.1	1.65	69.85
BP9BL0508SF44FF	BP9BL0508SF14FF	2"	50.8	1.65	88.90
BP9BL0635SF44FF	BP9BL0635SF14FF	2-1/2"	63.5	1.65	107.95
BP9BL0762SF44FF	BP9BL0762SF14FF	3"	76.2	1.65	127.00
BP9BL1016SF44FF	BP9BL1016SF14FF	4"	101.6	2.11	168.28
BP9BL1524SF44FF	BP9BL1524SF14FF	6"	152.4	2.77	266.70

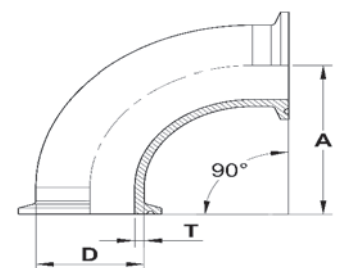

45°BEND (TUBE WELD)

Automatic Tube Weld : 45° Bend – ASME BPE – 2022 , DT-4.1.1-4

Order Code-SF4	Order Code-SF1	D, in.	D, mm	T, mm	A, mm
BP4BL0064SF44	BP4BL0064SF14	1/4"	6.35	0.89	50.80
BP4BL0095SF44	BP4BL0095SF14	3/8"	9.53	0.89	50.80
BP4BL0127SF44	BP4BL0127SF14	1/2"	12.70	1.65	57.15
BP4BL0191SF44	BP4BL0191SF14	3/4"	19.05	1.65	57.15
BP4BL0254SF44	BP4BL0254SF14	1"	25.40	1.65	57.15
BP4BL0381SF44	BP4BL0381SF14	1-1/2"	38.10	1.65	63.50
BP4BL0508SF44	BP4BL0508SF14	2"	50.80	1.65	76.20
BP4BL0635SF44	BP4BL0635SF14	2-1/2"	63.50	1.65	85.73
BP4BL0762SF44	BP4BL0762SF14	3"	76.20	1.65	92.08
BP4BL1016SF44	BP4BL1016SF14	4"	101.60	2.11	114.30
BP4BL1524SF44	BP4BL1524SF14	6"	152.4	2.77	158.75

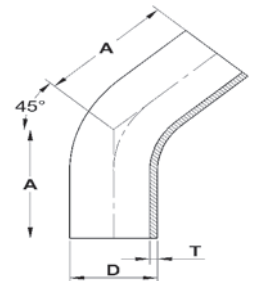

45°BEND (TUBE WELD HYGIENIC CLAMP JOINT)

Automatic Tube Weld :Hygienic Clamp Joint-45° Bend –ASME BPE – 2022 , DT-4.1.1-5

Order Code-SF4	Order Code-SF1	D, in.	D, mm	T, mm	A, mm	B, mm
BP4BL0064SF44F	BP4BL0064SF14F	1/4"	6.35	0.89	50.80	25.40
BP4BL0095SF44F	BP4BL0095SF14F	3/8"	9.53	0.89	50.80	25.40
BP4BL0127SF44F	BP4BL0127SF14F	1/2"	12.70	1.65	57.15	25.40
BP4BL0191SF44F	BP4BL0191SF14F	3/4"	19.05	1.65	57.15	25.40
BP4BL0254SF44F	BP4BL0254SF14F	1"	25.40	1.65	57.15	28.58
BP4BL0381SF44F	BP4BL0381SF14F	1-1/2"	38.10	1.65	63.50	36.53
BP4BL0508SF44F	BP4BL0508SF14F	2"	50.80	1.65	76.20	44.45
BP4BL0635SF44F	BP4BL0635SF14F	2-1/2"	63.50	1.65	85.73	52.40
BP4BL0762SF44F	BP4BL0762SF14F	3"	76.20	1.65	92.08	60.33
BP4BL1016SF44F	BP4BL1016SF14F	4"	101.60	2.11	114.30	79.38
BP4BL1524SF44F	BP4BL1524SF14F	6"	152.4	2.77	158.75	133.35

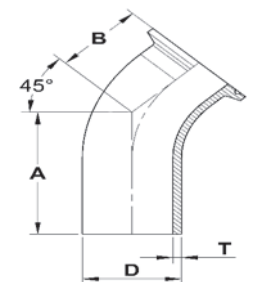

45°BEND (HYGIENIC CLAMP JOINT)

Hygienic Clamp Joint:45° Bend –ASME BPE – 2022, DT-4.1.1-6

Order Code-SF4	Order Code-SF1	D, in.	D, mm	T, mm	A, mm
BP4BL0064SF44FF	BP4BL0064SF14FF	1/4"	6.35	0.89	25.40
BP4BL0095SF44FF	BP4BL0095SF14FF	3/8"	9.53	0.89	25.40
BP4BL0127SF44FF	BP4BL0127SF14FF	1/2"	12.70	1.65	25.40
BP4BL0191SF44FF	BP4BL0191SF14FF	3/4"	19.05	1.65	25.40
BP4BL0254SF44FF	BP4BL0254SF14FF	1"	25.40	1.65	28.58
BP4BL0381SF44FF	BP4BL0381SF14FF	1-1/2"	38.10	1.65	36.53
BP4BL0508SF44FF	BP4BL0508SF14FF	2"	50.80	1.65	44.45
BP4BL0635SF44FF	BP4BL0635SF14FF	2-1/2"	63.50	1.65	52.40
BP4BL0762SF44FF	BP4BL0762SF14FF	3"	76.20	1.65	30.33
BP4BL1016SF44FF	BP4BL1016SF14FF	4"	101.60	2.11	79.38
BP4BL1524SF44FF	BP4BL1524SF14FF	6"	152.4	2.77	133.53

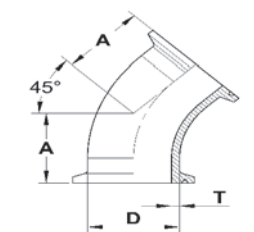

180° RETURN BEND (TUBE WELD)

Automatic Tube Weld: 180° Return Bend-ASME BPE – 2022, DT-4.1.1-7

Order Code-SF4	Order Code-SF1	D, in.	D, mm	T, mm	A, mm	B, mm
BP18BL0064SF44	BP18BL0064SF14	1/4"	6.35	0.89	114.30	66.68
BP18BL0095SF44	BP18BL0095SF14	3/8"	9.53	0.89	114.30	66.68
BP18BL0127SF44	BP18BL0127SF14	1/2"	12.70	1.65	114.30	76.20
BP18BL0191SF44	BP18BL0191SF14	3/4"	19.05	1.65	114.30	76.20
BP18BL0254SF44	BP18BL0254SF14	1"	25.40	1.65	76.20	76.20
BP18BL0381SF44	BP18BL0381SF14	1-1/2"	38.10	1.65	114.30	114.30
BP18BL0508SF44	BP18BL0508SF14	2"	50.80	1.65	152.40	127.00
BP18BL0635SF44	BP18BL0635SF14	2-1/2"	63.50	1.65	190.50	146.05
BP18BL0762SF44	BP18BL0762SF14	3"	76.20	1.65	228.60	165.10
BP18BL1016SF44	BP18BL1016SF14	4"	101.60	2.11	304.80	215.90
BP18BL1524SF44	BP18BL1524SF14	6"	152.4	2.77	457.20	292.10

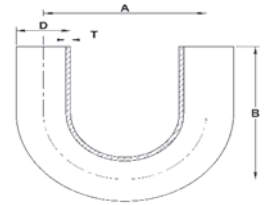

180° RETURN BEND (HYGIENIC CLAMP JOINT)

Hygienic Clamp Joint: 180° Return Bend – ASME BPE – 2022, DT-4.1.1-8

Order Code-SF4	Order Code-SF1	D, in.	D, mm	T, mm	A, mm	B, mm
BP18BL0064SF44FF	BP18BL0064SF14FF	1/4"	6.35	0.89	114.30	79.38
BP18BL0095SF44FF	BP18BL0095SF14FF	3/8"	9.53	0.89	114.30	79.38
BP18BL0127SF44FF	BP18BL0127SF14FF	1/2"	12.70	1.65	114.30	88.90
BP18BL0191SF44FF	BP18BL0191SF14FF	3/4"	19.05	1.65	114.30	88.90
BP18BL0254SF44FF	BP18BL0254SF14FF	1"	25.40	1.65	76.20	88.90
BP18BL0381SF44FF	BP18BL0381SF14FF	1-1/2"	38.10	1.65	114.30	127.00
BP18BL0508SF44FF	BP18BL0508SF14FF	2"	50.80	1.65	152.40	139.70
BP18BL0635SF44FF	BP18BL0635SF14FF	2-1/2"	63.50	1.65	190.50	158.75
BP18BL0762SF44FF	BP18BL0762SF14FF	3"	76.20	1.65	228.60	177.80
BP18BL1016SF44FF	BP18BL1016SF14FF	4"	101.60	2.11	304.80	231.78
BP18BL1524SF44FF	BP18BL1524SF14FF	6"	152.4	2.77	457.20	330.20

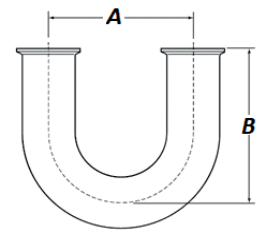

STRAIGHT TEE (TUBE WELD)

Automatic Tube Weld: Straight TEE-ASME BPE – 2022, DT-4.1.2-1

Order Code-SF4	Order Code-SF1	D, in.	D, mm	T, mm	A, mm
BPTL0064SF44	BPTL0064SF14	1/4"	6.35	0.89	44.45
BPTL0095SF44	BPTL0095SF14	3/8"	9.53	0.89	44.45
BPTL0127SF44	BPTL0127SF14	1/2"	12.70	1.65	47.63
BPTL0191SF44	BPTL0191SF14	3/4"	19.05	1.65	50.80
BPTL0254SF44	BPTL0254SF14	1"	25.40	1.65	53.98
BPTL0381SF44	BPTL0381SF14	1-1/2"	38.10	1.65	60.33
BPTL0508SF44	BPTL0508SF14	2"	50.80	1.65	73.03
BPTL0635SF44	BPTL0635SF14	2-1/2"	63.50	1.65	79.38
BPTL0762SF44	BPTL0762SF14	3"	76.20	1.65	85.73
BPTL1016SF44	BPTL1016SF14	4"	101.60	2.11	104.78
BPTL1524SF44	BPTL1524SF14	6"	152.40	2.77	142.88

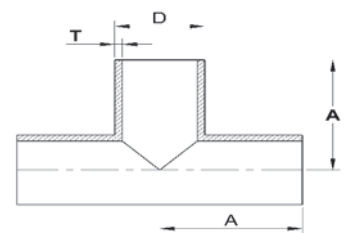

STRAIGHT CROSS (TUBE WELD)

Automatic Tube Weld: Straight Cross-ASME BPE – 2022 , DT-4.1.2-1

Order Code-SF4	Order Code-SF1	D, in.	D, mm	T, mm	A, mm
BPCS0064SF44	BPCS0064SF14	1/4"	6.35	0.89	44.45
BPCS0095SF44	BPCS0095SF14	3/8"	9.53	0.89	44.45
BPCS0127SF44	BPCS0127SF14	1/2"	12.70	1.65	47.63
BPCS0191SF44	BPCS0191SF14	3/4"	19.05	1.65	50.80
BPCS0254SF44	BPCS0254SF14	1"	25.40	1.65	53.98
BPCS0381SF44	BPCS0381SF14	1-1/2"	38.10	1.65	60.33
BPCS0508SF44	BPCS0508SF14	2"	50.80	1.65	73.03
BPCS0635SF44	BPCS0635SF14	2-1/2"	63.50	1.65	79.38
BPCS0762SF44	BPCS0762SF14	3"	76.20	1.65	85.73
BPCS1016SF44	BPCS1016SF14	4"	101.60	2.11	104.78
BPCS1524SF44	BPCS1524SF14	6"	152.40	2.77	142.88

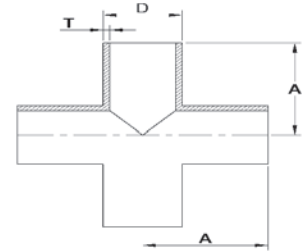

SHORT OUTLET TEE (TUBE WELD: HYGIENIC CLAMP JOINT)

Automatic Tube Weld :Short Outlet Hygienic Clamp Joint Tee –ASME BPE – 2022 , DT-4.1.2-2

Order Code-SF4	Order Code-SF1	D, in.	D, mm	T, mm	A, mm	B, mm
BPCB0064SF44F	BPCB0064SF14F	1/4"	6.35	0.89	44.45	25.40
BPCB0095SF44F	BPCB0095SF14F	3/8"	9.53	0.89	44.45	25.40
BPCB0127SF44F	BPCB0127SF14F	1/2"	12.70	1.65	47.63	25.40
BPCB0191SF44F	BPCB0191SF14F	3/4"	19.05	1.65	50.80	28.58
BPCB0254SF44F	BPCB0254SF14F	1"	25.40	1.65	53.98	28.58
BPCB0381SF44F	BPCB0381SF14F	1-1/2"	38.10	1.65	60.33	34.93
BPCB0508SF44F	BPCB0508SF14F	2"	50.80	1.65	73.03	41.28
BPCB0635SF44F	BPCB0635SF14F	2-1/2"	63.50	1.65	79.38	47.63
BPCB0762SF44F	BPCB0762SF14F	3"	76.20	1.65	85.73	53.98
BPCB1016SF44F	BPCB1016SF14F	4"	101.60	2.11	104.78	69.85
BPCB1524SF44F	BPCB1524SF14F	6"	152.4	2.77	142.88	117.48

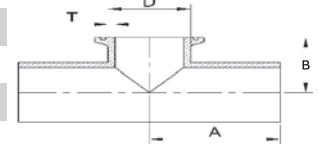

SHORT OUTLET RUN TEE (HYGIENIC MECHANICAL JOINT)

Hygienic Mechanical Joint: Short-Outlet Run TEE-ASME BPE – 2022, DT-4.1.2-3

Order Code-SF4	Order Code-SF1	D, in.	D, mm	T, mm	A, mm	B, mm	C, mm
BPRUNT0064SF44F	BPRUNT0064SF14F	1/4"	6.35	0.89	22.23	44.45	44.45
BPRUNT0095SF44F	BPRUNT0095SF14F	3/8"	9.53	0.89	22.23	44.45	44.45
BPRUNT0127SF44F	BPRUNT0127SF14F	1/2"	12.70	1.65	22.23	47.63	47.63
BPRUNT0191SF44F	BPRUNT0191SF14F	3/4"	19.05	1.65	25.40	50.80	50.80
BPRUNT0254SF44F	BPRUNT0254SF14F	1"	25.40	1.65	28.58	53.98	53.98
BPRUNT0381SF44F	BPRUNT0381SF14F	1-1/2"	38.10	1.65	34.93	60.33	60.33
BPRUNT0508SF44F	BPRUNT0508SF14F	2"	50.80	1.65	41.28	73.03	73.03
BPRUNT0635SF44F	BPRUNT0635SF14F	2-1/2"	63.50	1.65	47.63	79.38	79.38
BPRUNT0762SF44F	BPRUNT0762SF14F	3"	76.20	1.65	53.98	85.73	85.73
BPRUNT1016SF44F	BPRUNT1016SF14F	4"	101.60	2.11	69.85	104.78	104.78
BPRUNT1524SF44F	BPRUNT1524SF14F	6"	152.4	2.77	117.48	142.88	142.88

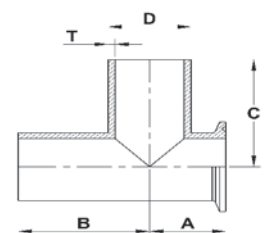

STRAIGHT TEE (HYGIENIC CLAMP JOINT)

Hygienic Clamp Joint: Straight Tee –ASME BPE – 2022 , DT-4.1.2-4

Order Code-SF4	Order Code-SF1	D, in.	D, mm	T, mm	A, mm
BPTL0064SF44FFF	BPTL0064SF14FFF	1/4"	6.35	0.89	57.15
BPTL0095SF44FFF	BPTL0095SF14FFF	3/8"	9.53	0.89	57.15
BPTL0127SF44FFF	BPTL0127SF14FFF	1/2"	12.70	1.65	60.33
BPTL0191SF44FFF	BPTL0191SF14FFF	3/4"	19.05	1.65	63.50
BPTL0254SF44FFF	BPTL0254SF14FFF	1"	25.40	1.65	66.68
BPTL0381SF44FFF	BPTL0381SF14FFF	1-1/2"	38.10	1.65	73.03
BPTL0508SF44FFF	BPTL0508SF14FFF	2"	50.80	1.65	85.73
BPTL0635SF44FFF	BPTL0635SF14FFF	2-1/2"	63.50	1.65	92.08
BPTL0762SF44FFF	BPTL0762SF14FFF	3"	76.20	1.65	98.43
BPTL1016SF44FFF	BPTL1016SF14FFF	4"	101.60	2.11	120.65
BPTL1524SF44FFF	BPTL1524SF14FFF	6"	152.40	2.77	180.98

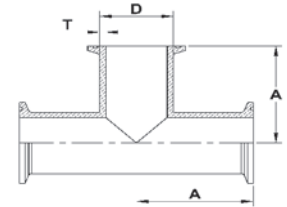

STRAIGHT CROSS (HYGIENIC CLAMP JOINT)

Hygienic Clamp Joint: Straight Cross –ASME BPE – 2022 , DT-4.1.2-4

Order Code-SF4	Order Code-SF1	D, in.	D, mm	T, mm	A, mm
BPCS0064SF44FFF	BPCS0064SF14FFF	1/4"	6.35	0.89	57.15
BPCS0095SF44FFF	BPCS0095SF14FFF	3/8"	9.53	0.89	57.15
BPCS0127SF44FFF	BPCS0127SF14FFF	1/2"	12.70	1.65	60.33
BPCS0191SF44FFF	BPCS0191SF14FFF	3/4"	19.05	1.65	63.50
BPCS0254SF44FFF	BPCS0254SF14FFF	1"	25.40	1.65	66.68
BPCS0381SF44FFF	BPCS0381SF14FFF	1-1/2"	38.10	1.65	73.03
BPCS0508SF44FFF	BPCS0508SF14FFF	2"	50.80	1.65	85.73
BPCS0635SF44FFF	BPCS0635SF14FFF	2-1/2"	63.50	1.65	92.08
BPCS0762SF44FFF	BPCS0762SF14FFF	3"	76.20	1.65	98.43
BPCS1016SF44FFF	BPCS1016SF14FFF	4"	101.60	2.11	120.65
BPCS1524SF44FFF	BPCS1524SF14FFF	6"	152.40	2.77	180.98

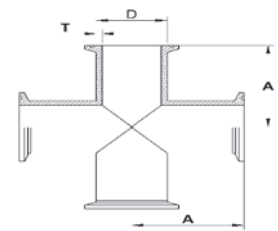

SHORT OUTLET TEE (CLAMP JOINT)

Hygienic Clamp Joint: Short Outlet Tee –ASME BPE – 2022 , DT-4.1.2-5

Order Code-SF4	Order Code-SF1	D, in.	D, mm	T, mm	A, mm	B, mm
BPCB0127SF44FFF	BPCB0127SF14FFF	1/2"	12.70	1.65	60.33	25.40
BPCB0191SF44FFF	BPCB0191SF14FFF	3/4"	19.05	1.65	63.50	28.58
BPCB0254SF44FFF	BPCB0254SF14FFF	1"	25.40	1.65	66.68	28.58
BPCB0381SF44FFF	BPCB0381SF14FFF	1-1/2"	38.10	1.65	73.03	34.93
BPCB0508SF44FFF	BPCB0508SF14FFF	2"	50.80	1.65	85.73	41.28
BPCB0635SF44FFF	BPCB0635SF14FFF	2-1/2"	63.50	1.65	92.08	47.63
BPCB0762SF44FFF	BPCB0762SF14FFF	3"	76.20	1.65	98.43	53.98
BPCB1016SF44FFF	BPCB1016SF14FFF	4"	101.60	2.11	120.65	69.85
BPCB1524SF44FFF	BPCB1524SF14FFF	6"	152.4	2.77	180.98	117.48

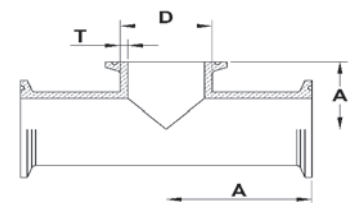

REDUCING TEE (TUBE WELD)

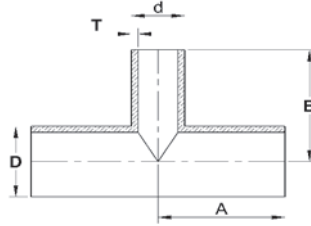

Automatic Tube Weld: Reducing Tee-ASME BPE -2022,DT-4.1.2-6

Order Code-SF4	Order Code-SF1	D, in.	d, in.	D, mm	d, mm	A, mm	B, mm
BPRTL00950064SF44	BPRTL00950064SF14	3/8"	1/4"	9.53	6.35	44.45	44.45
BPRTL01270064SF44	BPRTL01270064SF14	1/2"	1/4"	12.70	6.35	47.63	47.63
BPRTL01270095SF44	BPRTL01270095SF14	1/2"	3/8"	12.70	9.53	47.63	47.63
BPRTL01910064SF44	BPRTL01910064SF14	3/4"	1/4"	19.05	6.35	50.80	50.80
BPRTL01910095SF44	BPRTL01910095SF14	3/4"	3/8"	19.05	9.53	50.80	50.80
BPRTL01910127SF44	BPRTL01910127SF14	3/4"	1/2"	19.05	12.70	50.80	50.80
BPRTL02540064SF44	BPRTL02540064SF14	1"	1/4"	25.40	6.35	53.98	53.98
BPRTL02540095SF44	BPRTL02540095SF14	1"	3/8"	25.40	9.53	53.98	53.98
BPRTL02540127SF44	BPRTL02540127SF14	1"	1/2"	25.40	12.70	53.98	53.98
BPRTL02540191SF44	BPRTL02540191SF14	1"	3/4"	25.40	19.05	53.98	53.98
BPRTL03810127SF44	BPRTL03810127SF14	1-1/2"	1/2"	38.10	12.70	60.33	60.33
BPRTL03810191SF44	BPRTL03810191SF14	1-1/2"	3/4"	38.10	19.05	60.33	60.33
BPRTL03810254SF44	BPRTL03810254SF14	1-1/2"	1"	38.10	25.40	60.33	60.33
BPRTL05080127SF44	BPRTL05080127SF14	2"	1/2"	50.80	12.70	73.03	66.68
BPRTL05080191SF44	BPRTL05080191SF14	2"	3/4"	50.80	19.05	73.03	66.68
BPRTL05080254SF44	BPRTL05080254SF14	2"	1"	50.80	25.40	73.03	66.68
BPRTL05080381SF44	BPRTL05080381SF14	2"	1-1/2"	50.80	38.10	73.03	66.68
BPRTL06350127SF44	BPRTL06350127SF14	2-1/2"	1/2"	63.50	12.70	79.38	73.03
BPRTL06350191SF44	BPRTL06350191SF14	2-1/2"	3/4"	63.50	19.05	79.38	73.03
BPRTL06350254SF44	BPRTL06350254SF14	2-1/2"	1"	63.50	25.40	79.38	73.03
BPRTL06350381SF44	BPRTL06350381SF14	2-1/2"	1-1/2"	63.50	38.10	79.38	73.03
BPRTL06350508SF44	BPRTL06350508SF14	2-1/2"	2"	63.50	50.80	79.38	73.03
BPRTL07620127SF44	BPRTL07620127SF14	3"	1/2"	76.20	12.70	85.73	79.38
BPRTL07620191SF44	BPRTL07620191SF14	3"	3/4"	76.20	19.05	85.73	79.38
BPRTL07620254SF44	BPRTL07620254SF14	3"	1"	76.20	25.40	85.73	79.38
BPRTL07620381SF44	BPRTL07620381SF14	3"	1-1/2"	76.20	38.10	85.73	79.38
BPRTL07620508SF44	BPRTL07620508SF14	3"	2"	76.20	50.80	85.73	79.38
BPRTL07620635SF44	BPRTL07620635SF14	3"	2-1/2"	76.20	63.50	85.73	79.38
BPRTL10160127SF44	BPRTL10160127SF14	4"	1/2"	101.60	12.70	104.78	92.08
BPRTL10160191SF44	BPRTL10160191SF14	4"	3/4"	101.60	19.05	104.78	92.08
BPRTL10160254SF44	BPRTL10160254SF14	4"	1"	101.60	25.40	104.78	92.08
BPRTL10160381SF44	BPRTL10160381SF14	4"	1-1/2"	101.60	38.10	104.78	92.08
BPRTL10160508SF44	BPRTL10160508SF14	4"	2"	101.60	50.80	104.78	98.43
BPRTL10160635SF44	BPRTL10160635SF14	4"	2-1/2"	101.60	63.50	104.78	98.43
BPRTL10160762SF44	BPRTL10160762SF14	4"	3"	101.60	76.20	104.78	98.43
BPRTL15240127SF44	BPRTL15240127SF14	6"	1/2"	152.40	12.70	142.88	117.48
BPRTL15240191SF44	BPRTL15240191SF14	6"	3/4"	152.40	19.05	142.88	117.48
BPRTL15240254SF44	BPRTL15240254SF14	6"	1"	152.40	25.40	142.88	117.48
BPRTL15240381SF44	BPRTL15240381SF14	6"	1-1/2"	152.40	38.10	142.88	117.48
BPRTL15240508SF44	BPRTL15240508SF14	6"	2"	152.40	50.80	142.88	123.83
BPRTL15240635SF44	BPRTL15240635SF14	6"	2-1/2"	152.40	63.50	142.88	123.83
BPRTL15240762SF44	BPRTL15240762SF14	6"	3"	152.40	76.20	142.88	123.83
BPRTL15241016SF44	BPRTL15241016SF14	6"	4"	152.40	101.60	142.88	130.18

SHORT OUTLET REDUCING TEE (TUBE WELD & HYGIENIC CLAMP JOINT)

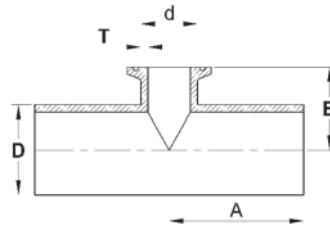

Automatic Tube Weld: Short Outlet Hygienic Clamp Joint Reducing Tee-ASME BPE -2022,DT-4.1.2-7

Order Code-SF4	Order Code-SF1	D, in.	d, in.	D, mm	d, mm	A, mm	B, mm
BPRCB00950064SF44F	BPRCB00950064SF14F	3/8"	1/4"	9.53	6.35	44.45	25.40
BPRCB01270064SF44F	BPRCB01270064SF14F	1/2"	1/4"	12.70	6.35	47.63	25.40
BPRCB01270095SF44F	BPRCB01270095SF14F	1/2"	3/8"	12.70	9.53	47.63	25.40
BPRCB01910064SF44F	BPRCB01910064SF14F	3/4"	1/4"	19.05	6.35	50.80	25.40
BPRCB01910095SF44F	BPRCB01910095SF14F	3/4"	3/8"	19.05	9.53	50.80	25.40
BPRCB01910127SF44F	BPRCB01910127SF14F	3/4"	1/2"	19.05	12.70	50.80	25.40
BPRCB0254064SF44F	BPRCB0254064SF14F	1"	1/4"	25.40	6.35	53.98	28.58
BPRCB02540095SF44F	BPRCB02540095SF14F	1"	3/8"	25.40	9.53	53.98	28.58
BPRCB02540127SF44F	BPRCB02540127SF14F	1"	1/2"	25.40	12.70	53.98	28.58
BPRCB02540191SF44F	BPRCB02540191SF14F	1"	3/4"	25.40	19.05	53.98	28.58
BPRCB03810127SF44F	BPRCB03810127SF14F	1-1/2"	1/2"	38.10	12.70	60.33	34.93
BPRCB03810191SF44F	BPRCB03810191SF14F	1-1/2"	3/4"	38.10	19.05	60.33	34.93
BPRCB03810254SF44F	BPRCB03810254SF14F	1-1/2"	1"	38.10	25.40	60.33	34.93
BPRCB05080127SF44F	BPRCB05080127SF14F	2"	1/2"	50.80	12.70	73.03	41.28
BPRCB05080191SF44F	BPRCB05080191SF14F	2"	3/4"	50.80	19.05	73.03	41.28
BPRCB05080254SF44F	BPRCB05080254SF14F	2"	1"	50.80	25.40	73.03	41.28
BPRCB05080381SF44F	BPRCB05080381SF14F	2"	1-1/2"	50.80	38.10	73.03	41.28
BPRCB06350127SF44F	BPRCB06350127SF14F	2-1/2"	1/2"	63.50	12.70	79.38	47.63
BPRCB06350191SF44F	BPRCB06350191SF14F	2-1/2"	3/4"	63.50	19.05	79.38	47.63
BPRCB06350254SF44F	BPRCB06350254SF14F	2-1/2"	1"	63.50	25.40	79.38	47.63
BPRCB06350381SF44F	BPRCB06350381SF14F	2-1/2"	1-1/2"	63.50	38.10	79.38	47.63
BPRCB06350508SF44F	BPRCB06350508SF14F	2-1/2"	2"	63.50	50.80	79.38	47.63
BPRCB07620127SF44F	BPRCB07620127SF14F	3"	1/2"	76.20	12.70	85.73	53.98
BPRCB07620191SF44F	BPRCB07620191SF14F	3"	3/4"	76.20	19.05	85.73	53.98
BPRCB07620254SF44F	BPRCB07620254SF14F	3"	1"	76.20	25.40	85.73	53.98
BPRCB07620381SF44F	BPRCB07620381SF14F	3"	1-1/2"	76.20	38.10	85.73	53.98
BPRCB07620508SF44F	BPRCB07620508SF14F	3"	2"	76.20	50.80	85.73	53.98
BPRCB07620635SF44F	BPRCB07620635SF14F	3"	2-1/2"	76.20	63.50	85.73	53.98
BPRCB10160127SF44F	BPRCB10160127SF14F	4"	1/2"	101.60	12.70	104.78	66.68
BPRCB10160191SF44F	BPRCB10160191SF14F	4"	3/4"	101.60	19.05	104.78	66.68
BPRCB10160254SF44F	BPRCB10160254SF14F	4"	1"	101.60	25.40	104.78	66.68
BPRCB10160381SF44F	BPRCB10160381SF14F	4"	1-1/2"	101.60	38.10	104.78	66.68
BPRCB10160508SF44F	BPRCB10160508SF14F	4"	2"	101.60	50.80	104.78	66.68
BPRCB10160635SF44F	BPRCB10160635SF14F	4"	2-1/2"	101.60	63.50	104.78	66.68
BPRCB10160762SF44F	BPRCB10160762SF14F	4"	3"	101.60	76.20	104.78	66.68
BPRCB15240127SF44F	BPRCB15240127SF14F	6"	1/2"	152.40	12.70	142.88	92.08
BPRCB15240191SF44F	BPRCB15240191SF14F	6"	3/4"	152.40	19.05	142.88	92.08
BPRCB15240254SF44F	BPRCB15240254SF14F	6"	1"	152.40	25.40	142.88	92.08
BPRCB15240381SF44F	BPRCB15240381SF14F	6"	1-1/2"	152.40	38.10	142.88	92.08
BPRCB15240508SF44F	BPRCB15240508SF14F	6"	2"	152.40	50.80	142.88	92.08
BPRCB15240635SF44F	BPRCB15240635SF14F	6"	2-1/2"	152.40	63.50	142.88	92.08
BPRCB15240762SF44F	BPRCB15240762SF14F	6"	3"	152.40	76.20	142.88	92.08
BPRCB15241016SF44F	BPRCB15241016SF14F	6"	4"	152.40	101.60	142.88	95.25

REDUCING TEE (HYGIENIC CLAMP JOINT)

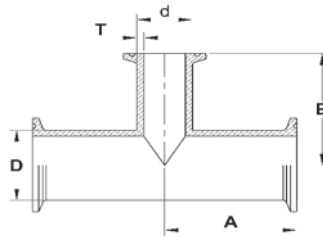

Hygienic Clamp Joint: Reducing Tee-ASME BPE -2022,DT-4.1.2-8							
Order Code-SF4	Order Code-SF1	D, in.	d, in.	D, mm	d, mm	A, mm	B, mm
BPRTL00950064SF44FFF	BPRTL00950064SF14FFF	3/8"	1/4"	9.53	6.35	57.15	57.15
BPRTL01270064SF44FFF	BPRTL01270064SF14FFF	1/2"	1/4"	12.70	6.35	60.33	60.33
BPRTL01270095SF44FFF	BPRTL01270095SF14FFF	1/2"	3/8"	12.70	9.53	60.33	60.33
BPRTL01910064SF44FFF	BPRTL01910064SF14FFF	3/4"	1/4"	19.05	6.35	63.50	63.50
BPRTL01910095SF44FFF	BPRTL01910095SF14FFF	3/4"	3/8"	19.05	9.53	63.50	63.50
BPRTL01910127SF44FFF	BPRTL01910127SF14FFF	3/4"	1/2"	19.05	12.70	63.50	63.50
BPRTL02540064SF44FFF	BPRTL02540064SF14FFF	1"	1/4"	25.40	6.35	66.68	66.68
BPRTL02540095SF44FFF	BPRTL02540095SF14FFF	1"	3/8"	25.40	9.53	66.68	66.68
BPRTL02540127SF44FFF	BPRTL02540127SF14FFF	1"	1/2"	25.40	12.70	66.68	66.68
BPRTL02540191SF44FFF	BPRTL02540191SF14FFF	1"	3/4"	25.40	19.05	66.68	66.68
BPRTL03810127SF44FFF	BPRTL03810127SF14FFF	1-1/2"	1/2"	38.10	12.70	73.03	73.03
BPRTL03810191SF44FFF	BPRTL03810191SF14FFF	1-1/2"	3/4"	38.10	19.05	73.03	73.03
BPRTL03810254SF44FFF	BPRTL03810254SF14FFF	1-1/2"	1"	38.10	25.40	73.03	73.03
BPRTL05080127SF44FFF	BPRTL05080127SF14FFF	2"	1/2"	50.80	12.70	85.73	79.38
BPRTL05080191SF44FFF	BPRTL05080191SF14FFF	2"	3/4"	50.80	19.05	85.73	79.38
BPRTL05080254SF44FFF	BPRTL05080254SF14FFF	2"	1"	50.80	25.40	85.73	79.38
BPRTL05080381SF44FFF	BPRTL05080381SF14FFF	2"	1-1/2"	50.80	38.10	85.73	79.38
BPRTL06350127SF44FFF	BPRTL06350127SF14FFF	2-1/2"	1/2"	63.50	12.70	92.08	85.73
BPRTL06350191SF44FFF	BPRTL06350191SF14FFF	2-1/2"	3/4"	63.50	19.05	92.08	85.73
BPRTL06350254SF44FFF	BPRTL06350254SF14FFF	2-1/2"	1"	63.50	25.40	92.08	85.73
BPRTL06350381SF44FFF	BPRTL06350381SF14FFF	2-1/2"	1-1/2"	63.50	38.10	92.08	85.73
BPRTL06350508SF44FFF	BPRTL06350508SF14FFF	2-1/2"	2"	63.50	50.80	92.08	85.73
BPRTL07620127SF44FFF	BPRTL07620127SF14FFF	3"	1/2"	76.20	12.70	98.43	92.08
BPRTL07620191SF44FFF	BPRTL07620191SF14FFF	3"	3/4"	76.20	19.05	98.43	92.08
BPRTL07620254SF44FFF	BPRTL07620254SF14FFF	3"	1"	76.20	25.40	98.43	92.08
BPRTL07620381SF44FFF	BPRTL07620381SF14FFF	3"	1-1/2"	76.20	38.10	98.43	92.08
BPRTL07620508SF44FFF	BPRTL07620508SF14FFF	3"	2"	76.20	50.80	98.43	92.08
BPRTL07620635SF44FFF	BPRTL07620635SF14FFF	3"	2-1/2"	76.20	63.50	98.43	92.08
BPRTL10160127SF44FFF	BPRTL10160127SF14FFF	4"	1/2"	101.60	12.70	120.65	104.78
BPRTL10160191SF44FFF	BPRTL10160191SF14FFF	4"	3/4"	101.60	19.05	120.65	104.78
BPRTL10160254SF44FFF	BPRTL10160254SF14FFF	4"	1"	101.60	25.40	120.65	104.78
BPRTL10160381SF44FFF	BPRTL10160381SF14FFF	4"	1-1/2"	101.60	38.10	120.65	104.78
BPRTL10160508SF44FFF	BPRTL10160508SF14FFF	4"	2"	101.60	50.80	120.65	111.13
BPRTL10160635SF44FFF	BPRTL10160635SF14FFF	4"	2-1/2"	101.60	63.50	120.65	111.13
BPRTL10160762SF44FFF	BPRTL10160762SF14FFF	4"	3"	101.60	76.20	120.65	111.13
BPRTL15240127SF44FFF	BPRTL15240127SF14FFF	6"	1/2"	152.40	12.70	180.98	130.18
BPRTL15240191SF44FFF	BPRTL15240191SF14FFF	6"	3/4"	152.40	19.05	180.98	130.18
BPRTL15240254SF44FFF	BPRTL15240254SF14FFF	6"	1"	152.40	25.40	180.98	130.18
BPRTL15240381SF44FFF	BPRTL15240381SF14FFF	6"	1-1/2"	152.40	38.10	180.98	130.18
BPRTL15240508SF44FFF	BPRTL15240508SF14FFF	6"	2"	152.40	50.80	180.98	136.53
BPRTL15240635SF44FFF	BPRTL15240635SF14FFF	6"	2-1/2"	152.40	63.50	180.98	136.53
BPRTL15240762SF44FFF	BPRTL15240762SF14FFF	6"	3"	152.40	76.20	180.98	136.53
BPRTL15241016SF44FFF	BPRTL15241016SF14FFF	6"	4"	152.40	101.60	180.98	146.05

SHORT OUTLET REDUCING TEE (HYGIENIC CLAMP JOINT)

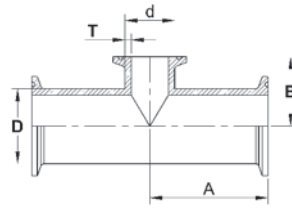

Hygienic Clamp Joint: Short Outlet Reducing Tee-ASME BPE -2022,DT-4.1.2-9							
Order Code-SF4	Order Code-SF1	D, in.	d, in.	D, mm	d, mm	A, mm	B, mm
BPRCB00950064SF44FFF	BPRCB00950064SF14FFF	3/8"	1/4"	9.53	6.35	57.15	25.40
BPRCB01270064SF44FFF	BPRCB01270064SF14FFF	1/2"	1/4"	12.70	6.35	60.33	25.40
BPRCB01270095SF44FFF	BPRCB01270095SF14FFF	1/2"	3/8"	12.70	9.53	60.33	25.40
BPRCB01910064SF44FFF	BPRCB01910064SF14FFF	3/4"	1/4"	19.05	6.35	63.50	25.40
BPRCB01910095SF44FFF	BPRCB01910095SF14FFF	3/4"	3/8"	19.05	9.53	63.50	25.40
BPRCB01910127SF44FFF	BPRCB01910127SF14FFF	3/4"	1/2"	19.05	12.70	63.50	25.40
BPRCB02540064SF44FFF	BPRCB02540064SF14FFF	1"	1/4"	25.40	6.35	66.68	28.58
BPRCB02540095SF44FFF	BPRCB02540095SF14FFF	1"	3/8"	25.40	9.53	66.68	28.58
BPRCB02540127SF44FFF	BPRCB02540127SF14FFF	1"	1/2"	25.40	12.70	66.68	28.58
BPRCB02540191SF44FFF	BPRCB02540191SF14FFF	1"	3/4"	25.40	19.05	66.68	28.58
BPRCB03810127SF44FFF	BPRCB03810127SF14FFF	1-1/2"	1/2"	38.10	12.70	73.03	34.93
BPRCB03810191SF44FFF	BPRCB03810191SF14FFF	1-1/2"	3/4"	38.10	19.05	73.03	34.93
BPRCB03810254SF44FFF	BPRCB03810254SF14FFF	1-1/2"	1"	38.10	25.40	73.03	34.93
BPRCB05080127SF44FFF	BPRCB05080127SF14FFF	2"	1/2"	50.80	12.70	85.73	41.28
BPRCB05080191SF44FFF	BPRCB05080191SF14FFF	2"	3/4"	50.80	19.05	85.73	41.28
BPRCB05080254SF44FFF	BPRCB05080254SF14FFF	2"	1"	50.80	25.40	85.73	41.28
BPRCB05080381SF44FFF	BPRCB05080381SF14FFF	2"	1-1/2"	50.80	38.10	85.73	41.28
BPRCB06350127SF44FFF	BPRCB06350127SF14FFF	2-1/2"	1/2"	63.50	12.70	92.08	47.63
BPRCB06350191SF44FFF	BPRCB06350191SF14FFF	2-1/2"	3/4"	63.50	19.05	92.08	47.63
BPRCB06350254SF44FFF	BPRCB06350254SF14FFF	2-1/2"	1"	63.50	25.40	92.08	47.63
BPRCB06350381SF44FFF	BPRCB06350381SF14FFF	2-1/2"	1-1/2"	63.50	38.10	92.08	47.63
BPRCB06350508SF44FFF	BPRCB06350508SF14FFF	2-1/2"	2"	63.50	50.80	92.08	47.63
BPRCB07620127SF44FFF	BPRCB07620127SF14FFF	3"	1/2"	76.20	12.70	98.43	53.98
BPRCB07620191SF44FFF	BPRCB07620191SF14FFF	3"	3/4"	76.20	19.05	98.43	53.98
BPRCB07620254SF44FFF	BPRCB07620254SF14FFF	3"	1"	76.20	25.40	98.43	53.98
BPRCB07620381SF44FFF	BPRCB07620381SF14FFF	3"	1-1/2"	76.20	38.10	98.43	53.98
BPRCB07620508SF44FFF	BPRCB07620508SF14FFF	3"	2"	76.20	50.80	98.43	53.98
BPRCB07620635SF44FFF	BPRCB07620635SF14FFF	3"	2-1/2"	76.20	63.50	98.43	53.98
BPRCB10160127SF44FFF	BPRCB10160127SF14FFF	4"	1/2"	101.60	12.70	120.65	66.68
BPRCB10160191SF44FFF	BPRCB10160191SF14FFF	4"	3/4"	101.60	19.05	120.65	66.68
BPRCB10160254SF44FFF	BPRCB10160254SF14FFF	4"	1"	101.60	25.40	120.65	66.68
BPRCB10160381SF44FFF	BPRCB10160381SF14FFF	4"	1-1/2"	101.60	38.10	120.65	66.68
BPRCB10160508SF44FFF	BPRCB10160508SF14FFF	4"	2"	101.60	50.80	120.65	66.68
BPRCB10160635SF44FFF	BPRCB10160635SF14FFF	4"	2-1/2"	101.60	63.50	120.65	66.68
BPRCB10160762SF44FFF	BPRCB10160762SF14FFF	4"	3"	101.60	76.20	120.65	66.68
BPRCB15240127SF44FFF	BPRCB15240127SF14FFF	6"	1/2"	152.40	12.70	180.98	92.08
BPRCB15240191SF44FFF	BPRCB15240191SF14FFF	6"	3/4"	152.40	19.05	180.98	92.08
BPRCB15240254SF44FFF	BPRCB15240254SF14FFF	6"	1"	152.40	25.40	180.98	92.08
BPRCB15240381SF44FFF	BPRCB15240381SF14FFF	6"	1-1/2"	152.40	38.10	180.98	92.08
BPRCB15240508SF44FFF	BPRCB15240508SF14FFF	6"	2"	152.40	50.80	180.98	92.08
BPRCB15240635SF44FFF	BPRCB15240635SF14FFF	6"	2-1/2"	152.40	63.50	180.98	92.08
BPRCB15240762SF44FFF	BPRCB15240762SF14FFF	6"	3"	152.40	76.20	180.98	92.08
BPRCB15241016SF44FFF	BPRCB15241016SF14FFF	6"	4"	152.40	101.60	180.98	95.25

INSTRUMENT TEE (TUBE WELD)

Automatic Tube Weld : Instrument Tee-ASME BPE -2022,DT-4.1.2-10

Order Code-SF4	Order Code-SF1	D, in.	d, in.	D, mm	d, mm	A, mm	B, mm
BPIT01270381SF44F	BPIT01270381SF14F	1/2"	1-1/2"	12.70	38.10	63.50	22.23
BPIT01910381SF44F	BPIT01910381SF14F	3/4"	1-1/2"	19.05	38.10	63.50	25.40
BPIT02540381SF44F	BPIT02540381SF14F	1"	1-1/2"	25.40	38.10	63.50	28.58
BPIT01270508SF44F	BPIT01270508SF14F	1/2"	2"	12.70	50.80	69.85	25.40
BPIT01910508SF44F	BPIT01910508SF14F	3/4"	2"	19.05	50.80	69.85	28.58
BPIT02540508SF44F	BPIT02540508SF14F	1"	2"	25.40	50.80	69.85	31.75
BPIT03810508SF44F	BPIT03810508SF14F	1-1/2"	2"	38.10	50.80	69.85	38.10

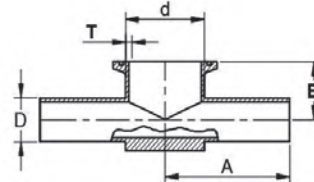

INSTRUMENT TEE (HYGIENIC CLAMP JOINT)

Hygienic Clamp Joint : Instrument Tee-ASME BPE -2022,DT-4.1.2-11

Order Code-SF4	Order Code-SF1	D, in.	d, in.	D, mm	d, mm	A, mm	B, mm
BPIT01270381SF44FFF	BPIT01270381SF14FFF	1/2"	1-1/2"	12.70	38.10	76.20	22.23
BPIT01910381SF44FFF	BPIT01910381SF14FFF	3/4"	1-1/2"	19.05	38.10	76.20	25.40
BPIT02540381SF44FFF	BPIT02540381SF14FFF	1"	1-1/2"	25.40	38.10	76.20	28.58
BPIT01270508SF44FFF	BPIT01270508SF14FFF	1/2"	2"	12.70	50.80	82.55	25.40
BPIT01910508SF44FFF	BPIT01910508SF14FFF	3/4"	2"	19.05	50.80	82.55	28.58
BPIT02540508SF44FFF	BPIT02540508SF14FFF	1"	2"	25.40	50.80	82.55	31.75
BPIT03810508SF44FFF	BPIT03810508SF14FFF	1-1/2"	2"	38.10	50.80	82.55	38.10

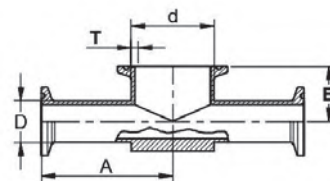

STANDARD OUTLET TEE (TUBE WELD & HYGIENIC CLAMP JOINT)

Automatic Tube Weld :Standard Outlet Hygienic Clamp Joint Tee - ASME BPE – 2022 , DT-4.1.2-12

Order Code-SF4	Order Code-SF1	D, in.	D, mm	T, mm	A, mm	B, mm
BPTL0064SF44F	BPTL0064SF14F	1/4"	6.35	0.89	44.45	57.15
BPTL0095SF44F	BPTL0095SF14F	3/8"	9.53	0.89	44.45	57.15
BPTL0127SF44F	BPTL0127SF14F	1/2"	12.70	1.65	47.63	60.33
BPTL0191SF44F	BPTL0191SF14F	3/4"	19.05	1.65	50.80	63.50
BPTL0254SF44F	BPTL0254SF14F	1"	25.40	1.65	53.98	66.68
BPTL0381SF44F	BPTL0381SF14F	1-1/2"	38.10	1.65	60.33	73.03
BPTL0508SF44F	BPTL0508SF14F	2"	50.80	1.65	73.03	85.73
BPTL0635SF44F	BPTL0635SF14F	2-1/2"	63.50	1.65	79.38	92.08
BPTL0762SF44F	BPTL0762SF14F	3"	76.20	1.65	85.73	98.43
BPTL1016SF44F	BPTL1016SF14F	4"	101.60	2.11	104.78	120.65
BPTL1524SF44F	BPTL1524SF14F	6"	152.40	2.77	142.88	180.98

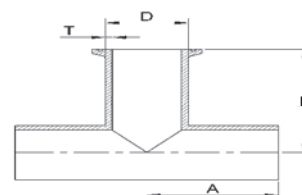

STANDARD OUTLET REDUCING TEE (TUBE WELD & HYGIENIC CLAMP JOINT)

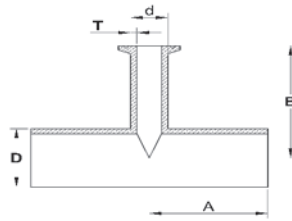

Automatic Tube Weld : Standard Outlet Hygienic Clamp Joint: Reducing Tee-ASME BPE -2022,DT-4.1.2-13

Order Code-SF4	Order Code-SF1	D, in.	d, in.	D, mm	d, mm	A, mm	B, mm
BPRTL00950064SF44F	BPRTL00950064SF14F	3/8"	1/4"	9.53	6.35	44.45	57.15
BPRTL01270064SF44F	BPRTL01270064SF14F	1/2"	1/4"	12.70	6.35	47.63	60.33
BPRTL01270095SF44F	BPRTL01270095SF14F	1/2"	3/8"	12.70	9.53	47.63	60.33
BPRTL01910064SF44F	BPRTL01910064SF14F	3/4"	1/4"	19.05	6.35	50.80	63.50
BPRTL01910095SF44F	BPRTL01910095SF14F	3/4"	3/8"	19.05	9.53	50.80	63.50
BPRTL01910127SF44F	BPRTL01910127SF14F	3/4"	1/2"	19.05	12.70	50.80	63.50
BPRTL02540064SF44F	BPRTL02540064SF14F	1"	1/4"	25.40	6.35	53.98	66.68
BPRTL02540095SF44F	BPRTL02540095SF14F	1"	3/8"	25.40	9.53	53.98	66.68
BPRTL02540127SF44F	BPRTL02540127SF14F	1"	1/2"	25.40	12.70	53.98	66.68
BPRTL02540191SF44F	BPRTL02540191SF14F	1"	3/4"	25.40	19.05	53.98	66.68
BPRTL03810127SF44F	BPRTL03810127SF14F	1-1/2"	1/2"	38.10	12.70	60.33	73.03
BPRTL03810191SF44F	BPRTL03810191SF14F	1-1/2"	3/4"	38.10	19.05	60.33	73.03
BPRTL03810254SF44F	BPRTL03810254SF14F	1-1/2"	1"	38.10	25.40	60.33	73.03
BPRTL05080127SF44F	BPRTL05080127SF14F	2"	1/2"	50.80	12.70	73.03	79.38
BPRTL05080191SF44F	BPRTL05080191SF14F	2"	3/4"	50.80	19.05	73.03	79.38
BPRTL05080254SF44F	BPRTL05080254SF14F	2"	1"	50.80	25.40	73.03	79.38
BPRTL05080381SF44F	BPRTL05080381SF14F	2"	1-1/2"	50.80	38.10	73.03	79.38
BPRTL06350127SF44F	BPRTL06350127SF14F	2-1/2"	1/2"	63.50	12.70	79.38	85.73
BPRTL06350191SF44F	BPRTL06350191SF14F	2-1/2"	3/4"	63.50	19.05	79.38	85.73
BPRTL06350254SF44F	BPRTL06350254SF14F	2-1/2"	1"	63.50	25.40	79.38	85.73
BPRTL06350381SF44F	BPRTL06350381SF14F	2-1/2"	1-1/2"	63.50	38.10	79.38	85.73
BPRTL06350508SF44F	BPRTL06350508SF14F	2-1/2"	2"	63.50	50.80	79.38	85.73
BPRTL07620127SF44F	BPRTL07620127SF14F	3"	1/2"	76.20	12.70	85.73	92.08
BPRTL07620191SF44F	BPRTL07620191SF14F	3"	3/4"	76.20	19.05	85.73	92.08
BPRTL07620254SF44F	BPRTL07620254SF14F	3"	1"	76.20	25.40	85.73	92.08
BPRTL07620381SF44F	BPRTL07620381SF14F	3"	1-1/2"	76.20	38.10	85.73	92.08
BPRTL07620508SF44F	BPRTL07620508SF14F	3"	2"	76.20	50.80	85.73	92.08
BPRTL07620635SF44F	BPRTL07620635SF14F	3"	2-1/2"	76.20	63.50	85.73	92.08
BPRTL10160127SF44F	BPRTL10160127SF14F	4"	1/2"	101.60	12.70	104.78	104.78
BPRTL10160191SF44F	BPRTL10160191SF14F	4"	3/4"	101.60	19.05	104.78	104.78
BPRTL10160254SF44F	BPRTL10160254SF14F	4"	1"	101.60	25.40	104.78	104.78
BPRTL10160381SF44F	BPRTL10160381SF14F	4"	1-1/2"	101.60	38.10	104.78	104.78
BPRTL10160508SF44F	BPRTL10160508SF14F	4"	2"	101.60	50.80	104.78	111.13
BPRTL10160635SF44F	BPRTL10160635SF14F	4"	2-1/2"	101.60	63.50	104.78	111.13
BPRTL10160762SF44F	BPRTL10160762SF14F	4"	3"	101.60	76.20	104.78	111.13
BPRTL15240762SF44F	BPRTL15240762SF14F	6"	3"	152.40	76.20	142.88	136.53
BPRTL15241016SF44F	BPRTL15241016SF14F	6"	4"	152.40	101.60	142.88	146.05

CONCENTRIC REDUCER (TUBE WELD)

Automatic Tube Weld Concentric Reducer -ASME BPE -2022, DT-4.1.3-1						
Order Code-SF4	Order Code-SF1	D, in.	d, in.	D, mm	d, mm	A, mm
BPCRL00950064SF44	BPCRL00950064SF14	3/8"	1/4"	9.53	6.35	41.28
BPCRL01270064SF44	BPCRL01270064SF14	1/2"	1/4"	12.70	6.35	47.63
BPCRL01270095SF44	BPCRL01270095SF14	1/2"	3/8"	12.70	9.53	47.63
BPCRL01910095SF44	BPCRL01910095SF14	3/4"	3/8"	19.05	9.53	50.80
BPCRL01910127SF44	BPCRL01910127SF14	3/4"	1/2"	19.05	12.70	53.98
BPCRL02540127SF44	BPCRL02540127SF14	1"	1/2"	25.40	12.70	63.50
BPCRL02540191SF44	BPCRL02540191SF14	1"	3/4"	25.40	19.05	53.98
BPCRL03810191SF44	BPCRL03810191SF14	1-1/2"	3/4"	38.10	19.05	76.20
BPCRL03810254SF44	BPCRL03810254SF14	1-1/2"	1"	38.10	25.40	63.50
BPCRL05080254SF44	BPCRL05080254SF14	2"	1"	50.80	25.40	85.73
BPCRL05080381SF44	BPCRL05080381SF14	2"	1-1/2"	50.80	38.10	63.50
BPCRL06350381SF44	BPCRL06350381SF14	2-1/2"	1-1/2"	63.50	38.10	85.73
BPCRL06350508SF44	BPCRL06350508SF14	2-1/2"	2"	63.50	50.80	63.50
BPCRL07620381SF44	BPCRL07620381SF14	3"	1-1/2"	76.20	38.10	107.95
BPCRL07620508SF44	BPCRL07620508SF14	3"	2"	76.20	50.80	85.73
BPCRL07620635SF44	BPCRL07620635SF14	3"	2-1/2"	76.20	63.50	66.68
BPCRL10160508SF44	BPCRL10160508SF14	4"	2"	101.60	50.80	130.18
BPCRL10160635SF44	BPCRL10160635SF14	4"	2-1/2"	101.60	63.50	107.95
BPCRL10160762SF44	BPCRL10160762SF14	4"	3"	101.60	76.20	98.43
BPCRL15240762SF44	BPCRL15240762SF14	6"	3"	152.40	76.20	184.15
BPCRL15241016SF44	BPCRL15241016SF14	6"	4"	152.40	101.60	142.88

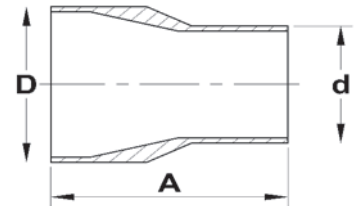

ECCENTRIC REDUCER (TUBE WELD)

Automatic Tube Weld Eccentric Reducer -ASME BPE -2022, DT-4.1.3-1						
Order Code-SF4	Order Code-SF1	D, in.	d, in.	D, mm	d, mm	A, mm
BPERL00950064SF44	BPERL00950064SF14	3/8"	1/4"	9.53	6.35	41.28
BPERL01270064SF44	BPERL01270064SF14	1/2"	1/4"	12.70	6.35	47.63
BPERL01270095SF44	BPERL01270095SF14	1/2"	3/8"	12.70	9.53	47.63
BPERL01910095SF44	BPERL01910095SF14	3/4"	3/8"	19.05	9.53	50.80
BPERL01910127SF44	BPERL01910127SF14	3/4"	1/2"	19.05	12.70	53.98
BPERL02540127SF44	BPERL02540127SF14	1"	1/2"	25.40	12.70	63.50
BPERL02540191SF44	BPERL02540191SF14	1"	3/4"	25.40	19.05	53.98
BPERL03810191SF44	BPERL03810191SF14	1-1/2"	3/4"	38.10	19.05	76.20
BPERL03810254SF44	BPERL03810254SF14	1-1/2"	1"	38.10	25.40	63.50
BPERL05080254SF44	BPERL05080254SF14	2"	1"	50.80	25.40	85.73
BPERL05080381SF44	BPERL05080381SF14	2"	1-1/2"	50.80	38.10	63.50
BPERL06350381SF44	BPERL06350381SF14	2-1/2"	1-1/2"	63.50	38.10	85.73
BPERL06350508SF44	BPERL06350508SF14	2-1/2"	2"	63.50	50.80	63.50
BPERL07620381SF44	BPERL07620381SF14	3"	1-1/2"	76.20	38.10	107.95
BPERL07620508SF44	BPERL07620508SF14	3"	2"	76.20	50.80	85.73
BPERL07620635SF44	BPERL07620635SF14	3"	2-1/2"	76.20	63.50	66.68
BPERL10160508SF44	BPERL10160508SF14	4"	2"	101.60	50.80	130.18
BPERL10160635SF44	BPERL10160635SF14	4"	2-1/2"	101.60	63.50	107.95
BPERL10160762SF44	BPERL10160762SF14	4"	3"	101.60	76.20	98.43
BPERL15240762SF44	BPERL15240762SF14	6"	3"	152.40	76.20	184.15
BPERL15241016SF44	BPERL15241016SF14	6"	4"	152.40	101.60	142.88

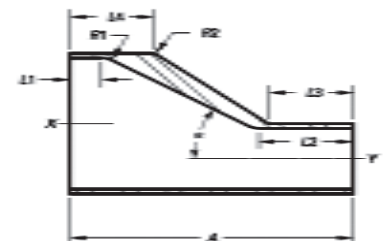

CONCENTRIC REDUCER (TUBE WELD - HYGIENIC CLAMP JOINT)

Hygienic Clamp Joint: Tube Weld Concentric Reducer-ASME BPE -2022, DT-4.1.3-2

Order Code-SF4	Order Code-SF1	D, in.	d, in.	D, mm	d, mm	A, mm
BPCRL00950064SF44F	BPCRL00950064SF14F	3/8"	1/4"	9.53	6.35	53.98
BPCRL01270064SF44F	BPCRL01270064SF14F	1/2"	1/4"	12.70	6.35	60.33
BPCRL01270095SF44F	BPCRL01270095SF14F	1/2"	3/8"	12.70	9.53	60.33
BPCRL01910095SF44F	BPCRL01910095SF14F	3/4"	3/8"	19.05	9.53	63.50
BPCRL01910127SF44F	BPCRL01910127SF14F	3/4"	1/2"	19.05	12.70	66.68
BPCRL02540127SF44F	BPCRL02540127SF14F	1"	1/2"	25.40	12.70	76.20
BPCRL02540191SF44F	BPCRL02540191SF14F	1"	3/4"	25.40	19.05	66.68
BPCRL03810191SF44F	BPCRL03810191SF14F	1-1/2"	3/4"	38.10	19.05	88.90
BPCRL03810254SF44F	BPCRL03810254SF14F	1-1/2"	1"	38.10	25.40	76.20
BPCRL05080254SF44F	BPCRL05080254SF14F	2"	1"	50.80	25.40	98.43
BPCRL05080381SF44F	BPCRL05080381SF14F	2"	1-1/2"	50.80	38.10	76.20
BPCRL06350381SF44F	BPCRL06350381SF14F	2-1/2"	1-1/2"	63.50	38.10	98.43
BPCRL06350508SF44F	BPCRL06350508SF14F	2-1/2"	2"	63.50	50.80	76.20
BPCRL07620381SF44F	BPCRL07620381SF14F	3"	1-1/2"	76.20	38.10	120.65
BPCRL07620508SF44F	BPCRL07620508SF14F	3"	2"	76.20	50.80	98.43
BPCRL07620635SF44F	BPCRL07620635SF14F	3"	2-1/2"	76.20	63.50	79.38
BPCRL10160508SF44F	BPCRL10160508SF14F	4"	2"	101.60	50.80	146.05
BPCRL10160635SF44F	BPCRL10160635SF14F	4"	2-1/2"	101.60	63.50	123.83
BPCRL10160762SF44F	BPCRL10160762SF14F	4"	3"	101.60	76.20	114.30
BPCRL15240762SF44F	BPCRL15240762SF14F	6"	3"	152.40	76.20	203.20
BPCRL15241016SF44F	BPCRL15241016SF14F	6"	4"	152.40	101.60	161.93

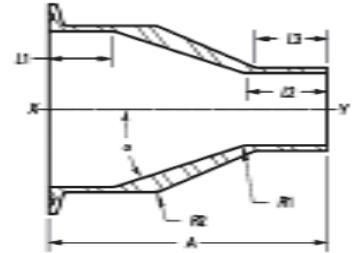

ECCENTRIC REDUCER (TUBE WELD - HYGIENIC CLAMP JOINT)

Hygienic Clamp Joint: Tube Weld Eccentric Reducer-ASME BPE -2022, DT-4.1.3-2

Order Code-SF4	Order Code-SF1	D, in.	d, in.	D, mm	d, mm	A, mm
BPERL00950064SF44F	BPERL00950064SF14F	3/8"	1/4"	9.53	6.35	53.98
BPERL01270064SF44F	BPERL01270064SF14F	1/2"	1/4"	12.70	6.35	60.33
BPERL01270095SF44F	BPERL01270095SF14F	1/2"	3/8"	12.70	9.53	60.33
BPERL01910095SF44F	BPERL01910095SF14F	3/4"	3/8"	19.05	9.53	63.50
BPERL01910127SF44F	BPERL01910127SF14F	3/4"	1/2"	19.05	12.70	66.68
BPERL02540127SF44F	BPERL02540127SF14F	1"	1/2"	25.40	12.70	76.20
BPERL02540191SF44F	BPERL02540191SF14F	1"	3/4"	25.40	19.05	66.68
BPERL03810191SF44F	BPERL03810191SF14F	1-1/2"	3/4"	38.10	19.05	88.90
BPERL03810254SF44F	BPERL03810254SF14F	1-1/2"	1"	38.10	25.40	76.20
BPERL05080254SF44F	BPERL05080254SF14F	2"	1"	50.80	25.40	98.43
BPERL05080381SF44F	BPERL05080381SF14F	2"	1-1/2"	50.80	38.10	76.20
BPERL06350381SF44F	BPERL06350381SF14F	2-1/2"	1-1/2"	63.50	38.10	98.43
BPERL06350508SF44F	BPERL06350508SF14F	2-1/2"	2"	63.50	50.80	76.20
BPERL07620381SF44F	BPERL07620381SF14F	3"	1-1/2"	76.20	38.10	120.65
BPERL07620508SF44F	BPERL07620508SF14F	3"	2"	76.20	50.80	98.43
BPERL07620635SF44F	BPERL07620635SF14F	3"	2-1/2"	76.20	63.50	79.38
BPERL10160508SF44F	BPERL10160508SF14F	4"	2"	101.60	50.80	146.05
BPERL10160635SF44F	BPERL10160635SF14F	4"	2-1/2"	101.60	63.50	123.83
BPERL10160762SF44F	BPERL10160762SF14F	4"	3"	101.60	76.20	114.30
BPERL15240762SF44F	BPERL15240762SF14F	6"	3"	152.40	76.20	203.20
BPERL15241016SF44F	BPERL15241016SF14F	6"	4"	152.40	101.60	161.93

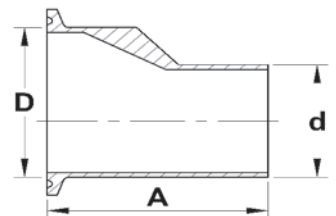

CONCENTRIC REDUCER (HYGIENIC CLAMP JOINT)

Hygienic Clamp Joint: Concentric Reducer-ASME BPE -2022, DT-4.1.3-3

Order Code-SF4	Order Code-SF1	D, in.	d, in.	D, mm	d, mm	A, mm
BPCRL00950064SF44FF	BPCRL00950064SF14FF	3/8"	1/4"	9.53	6.35	66.68
BPCRL01270064SF44FF	BPCRL01270064SF14FF	1/2"	1/4"	12.70	6.35	73.03
BPCRL01270095SF44FF	BPCRL01270095SF14FF	1/2"	3/8"	12.70	9.53	73.03
BPCRL01910095SF44FF	BPCRL01910095SF14FF	3/4"	3/8"	19.05	9.53	76.20
BPCRL01910127SF44FF	BPCRL01910127SF14FF	3/4"	1/2"	19.05	12.70	79.38
BPCRL02540127SF44FF	BPCRL02540127SF14FF	1"	1/2"	25.40	12.70	88.90
BPCRL02540191SF44FF	BPCRL02540191SF14FF	1"	3/4"	25.40	19.05	79.38
BPCRL03810191SF44FF	BPCRL03810191SF14FF	1-1/2"	3/4"	38.10	19.05	101.60
BPCRL03810254SF44FF	BPCRL03810254SF14FF	1-1/2"	1"	38.10	25.40	88.90
BPCRL05080254SF44FF	BPCRL05080254SF14FF	2"	1"	50.80	25.40	111.13
BPCRL05080381SF44FF	BPCRL05080381SF14FF	2"	1-1/2"	50.80	38.10	88.90
BPCRL06350381SF44FF	BPCRL06350381SF14FF	2-1/2"	1-1/2"	63.50	38.10	111.13
BPCRL06350508SF44FF	BPCRL06350508SF14FF	2-1/2"	2"	63.50	50.80	88.90
BPCRL07620381SF44FF	BPCRL07620381SF14FF	3"	1-1/2"	76.20	38.10	133.35
BPCRL07620508SF44FF	BPCRL07620508SF14FF	3"	2"	76.20	50.80	111.13
BPCRL07620635SF44FF	BPCRL07620635SF14FF	3"	2-1/2"	76.20	63.50	92.08
BPCRL10160508SF44FF	BPCRL10160508SF14FF	4"	2"	101.60	50.80	158.75
BPCRL10160635SF44FF	BPCRL10160635SF14FF	4"	2-1/2"	101.60	63.50	136.53
BPCRL10160762SF44FF	BPCRL10160762SF14FF	4"	3"	101.60	76.20	127.00
BPCRL15240762SF44FF	BPCRL15240762SF14FF	6"	3"	152.40	76.20	215.90
BPCRL15241016SF44FF	BPCRL15241016SF14FF	6"	4"	152.40	101.60	177.80

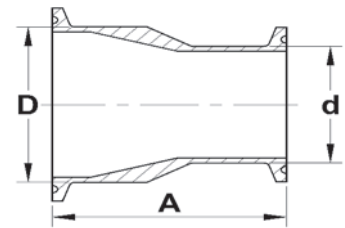

ECCENTRIC REDUCER (HYGIENIC CLAMP JOINT)

Hygienic Clamp Joint: Eccentric Reducer-ASME BPE -2022, DT-4.1.3-3

Order Code-SF4	Order Code-SF1	D, in.	d, in.	D, mm	d, mm	A, mm
BPERL00950064SF44FF	BPERL00950064SF14FF	3/8"	1/4"	9.53	6.35	66.68
BPERL01270064SF44FF	BPERL01270064SF14FF	1/2"	1/4"	12.70	6.35	73.03
BPERL01270095SF44FF	BPERL01270095SF14FF	1/2"	3/8"	12.70	9.53	73.03
BPERL01910095SF44FF	BPERL01910095SF14FF	3/4"	3/8"	19.05	9.53	76.20
BPERL01910127SF44FF	BPERL01910127SF14FF	3/4"	1/2"	19.05	12.70	79.38
BPERL02540127SF44FF	BPERL02540127SF14FF	1"	1/2"	25.40	12.70	88.90
BPERL02540191SF44FF	BPERL02540191SF14FF	1"	3/4"	25.40	19.05	79.38
BPERL03810191SF44FF	BPERL03810191SF14FF	1-1/2"	3/4"	38.10	19.05	101.60
BPERL03810254SF44FF	BPERL03810254SF14FF	1-1/2"	1"	38.10	25.40	88.90
BPERL05080254SF44FF	BPERL05080254SF14FF	2"	1"	50.80	25.40	111.13
BPERL05080381SF44FF	BPERL05080381SF14FF	2"	1-1/2"	50.80	38.10	88.90
BPERL06350381SF44FF	BPERL06350381SF14FF	2-1/2"	1-1/2"	63.50	38.10	111.13
BPERL06350508SF44FF	BPERL06350508SF14FF	2-1/2"	2"	63.50	50.80	88.90
BPERL07620381SF44FF	BPERL07620381SF14FF	3"	1-1/2"	76.20	38.10	133.35
BPERL07620508SF44FF	BPERL07620508SF14FF	3"	2"	76.20	50.80	111.13
BPERL07620635SF44FF	BPERL07620635SF14FF	3"	2-1/2"	76.20	63.50	92.08
BPERL10160508SF44FF	BPERL10160508SF14FF	4"	2"	101.60	50.80	158.75
BPERL10160635SF44FF	BPERL10160635SF14FF	4"	2-1/2"	101.60	63.50	136.53
BPERL10160762SF44FF	BPERL10160762SF14FF	4"	3"	101.60	76.20	127.00
BPERL15240762SF44FF	BPERL15240762SF14FF	6"	3"	152.40	76.20	215.90
BPERL15241016SF44FF	BPERL15241016SF14FF	6"	4"	152.40	101.60	177.80

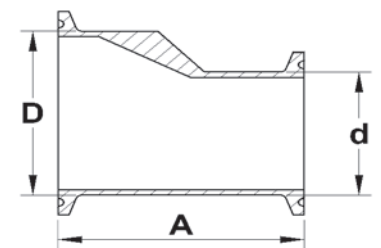

FERRULE (TUBE WELD)

Automatic Tube Weld: Ferrule-ASME BPE – 2022 , DT-4.1.4-1					
Order Code-SF4	Order Code-SF1	D, in.	D, mm	A, mm	Type-DT-7.1-1
BPFL0064SF44-A	BPFL0064SF14-A	1/4"	6.35	44.45	Type-A
BPFL0095SF44-A	BPFL0095SF14-A	3/8"	9.53	44.45	Type-A
BPFL0127SF44-A	BPFL0127SF14-A	1/2"	12.70	44.45	Type-A
BPFL0191SF44-A	BPFL0191SF14-A	3/4"	19.05	44.45	Type-A
BPFL0254SF44-A	BPFL0254SF14-A	1"	25.40	44.45	Type-A
BPFL0254SF44-B	BPFL0254SF14-B	1"	25.40	44.45	Type-B
BPFL0381SF44-B	BPFL0381SF14-B	1-1/2"	38.10	44.45	Type-B
BPFL0508SF44-B	BPFL0508SF14-B	2"	50.80	57.15	Type-B
BPFL0635SF44-B	BPFL0635SF14-B	2-1/2"	63.50	57.15	Type-B
BPFL0762SF44-B	BPFL0762SF14-B	3"	76.20	57.15	Type-B
BPFL1016SF44-B	BPFL1016SF14-B	4"	101.60	57.15	Type-B
BPFL1524SF44-B	BPFL1524SF14-B	6"	152.40	76.20	Type-B

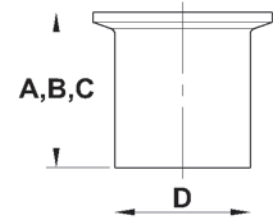

FERRULE (TUBE WELD)

Automatic Tube Weld: Ferrule-ASME BPE – 2022 , DT-4.1.4-1					
Order Code-SF4	Order Code-SF1	D, in.	D, mm	B, mm	Type-DT-7.1-1
BPFM0064SF44-A	BPFM0064SF14-A	1/4"	6.35	28.58	Type-A
BPFM0095SF44-A	BPFM0095SF14-A	3/8"	9.53	28.58	Type-A
BPFM0127SF44-A	BPFM0127SF14-A	1/2"	12.70	28.58	Type-A
BPFM0191SF44-A	BPFM0191SF14-A	3/4"	19.05	28.58	Type-A
BPFM0254SF44-A	BPFM0254SF14-A	1"	25.40	28.58	Type-A
BPFM0254SF44-B	BPFM0254SF14-B	1"	25.40	28.58	Type-B
BPFM0381SF44-B	BPFM0381SF14-B	1-1/2"	38.10	28.58	Type-B
BPFM0508SF44-B	BPFM0508SF14-B	2"	50.80	28.58	Type-B
BPFM0635SF44-B	BPFM0635SF14-B	2-1/2"	63.50	28.58	Type-B
BPFM0762SF44-B	BPFM0762SF14-B	3"	76.20	28.58	Type-B
BPFM1016SF44-B	BPFM1016SF14-B	4"	101.60	28.58	Type-B
BPFM1524SF44-B	BPFM1524SF14-B	6"	152.40	38.10	Type-B

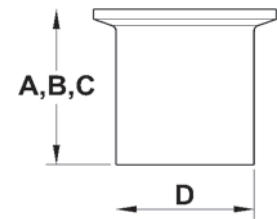

FERRULE (TUBE WELD)

Automatic Tube Weld: Ferrule-ASME BPE – 2022 , DT-4.1.4-1					
Order Code-SF4	Order Code-SF1	D, in.	D, mm	C, mm	Type-DT-7.1-1
BPFS0064SF44-A	BPFS0064SF14-A	1/4"	6.35	12.70	Type-A
BPFS0095SF44-A	BPFS0095SF14-A	3/8"	9.53	12.70	Type-A
BPFS0127SF44-A	BPFS0127SF14-A	1/2"	12.70	12.70	Type-A
BPFS0191SF44-A	BPFS0191SF14-A	3/4"	19.05	12.70	Type-A
BPFS0254SF44-A	BPFS0254SF14-A	1"	25.40	12.70	Type-A
BPFS0254SF44-B	BPFS0254SF14-B	1"	25.40	12.70	Type-B
BPFS0381SF44-B	BPFS0381SF14-B	1-1/2"	38.10	12.70	Type-B
BPFS0508SF44-B	BPFS0508SF14-B	2"	50.80	12.70	Type-B
BPFS0635SF44-B	BPFS0635SF14-B	2-1/2"	63.50	12.70	Type-B
BPFS0762SF44-B	BPFS0762SF14-B	3"	76.20	12.70	Type-B
BPFS1016SF44-B	BPFS1016SF14-B	4"	101.60	15.88	Type-B
BPFS1524SF44-B	BPFS1524SF14-B	6"	152.40	19.05	Type-B

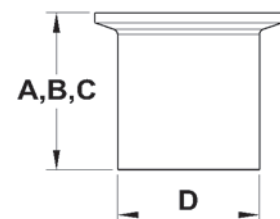

CAP (TUBE WELD)

Automatic Tube Weld : Cap -ASME BPE -2022,DT-4.1.5-1

Order Code-SF4	Order Code-SF1	D, in.	D, mm	A, mm	B, mm
BPTWC0064SF44	BPTWC0064SF14	1/4"	6.35	38.10	9.53
BPTWC0095SF44	BPTWC0095SF14	3/8"	9.53	38.10	9.53
BPTWC0127SF44	BPTWC0127SF14	1/2"	12.70	38.10	9.53
BPTWC0191SF44	BPTWC0191SF14	3/4"	19.05	38.10	9.53
BPTWC0254SF44	BPTWC0254SF14	1"	25.40	38.10	9.53
BPTWC0381SF44	BPTWC0381SF14	1-1/2"	38.10	38.10	9.53
BPTWC0508SF44	BPTWC0508SF14	2"	50.80	38.10	9.53
BPTWC0635SF44	BPTWC0635SF14	2-1/2"	63.50	38.10	9.53
BPTWC0762SF44	BPTWC0762SF14	3"	76.20	44.45	9.53
BPTWC1016SF44	BPTWC1016SF14	4"	101.60	50.80	9.53
BPTWC1524SF44	BPTWC1524SF14	6"	152.40	63.50	9.53

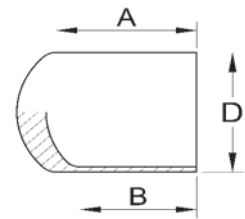

SOLID END CAP (HYGIENIC CLAMP JOINT)

Hygienic Clamp Joint : Solid End Cap-ASME BPE – 2022 , DT-4.1.5-2

Order Code-SF4	Order Code-SF1	D, in.	D, mm	A, mm	Type
BPCEC0064SF44-A	BPCEC0064SF14-A	1/4"	6.35	4.75	Type-A
BPCEC0095SF44-A	BPCEC0095SF14-A	3/8"	9.53	4.75	Type-A
BPCEC0127SF44-A	BPCEC0127SF14-A	1/2"	12.70	4.75	Type-A
BPCEC0191SF44-A	BPCEC0191SF14-A	3/4"	19.05	4.75	Type-A
BPCEC0254SF44-A	BPCEC0254SF14-A	1"	25.40	6.35	Type-A
BPCEC0254SF44-B	BPCEC0254SF14-B	1"	25.40	6.35	Type-B
BPCEC0381SF44-B	BPCEC0381SF14-B	1-1/2"	38.10	6.35	Type-B
BPCEC0508SF44-B	BPCEC0508SF14-B	2"	50.80	6.35	Type-B
BPCEC0635SF44-B	BPCEC0635SF14-B	2-1/2"	63.50	6.35	Type-B
BPCEC0762SF44-B	BPCEC0762SF14-B	3"	76.20	6.35	Type-B
BPCEC1016SF44-B	BPCEC1016SF14-B	4"	101.60	7.92	Type-B
BPCEC1524SF44-B	BPCEC1524SF14-B	6"	152.40	11.10	Type-B

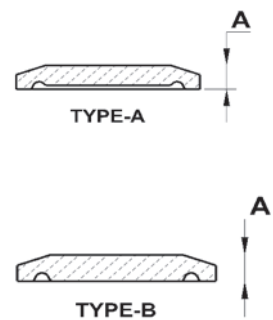



OUR CUSTOMER-CENTRIC APPROACH

Trust us to deliver on commitments

OUR SUPPORT

Assured. Consistent and timely



At rensa, we are fully dedicated in the trust our customers bestow upon us and are committed to provide unwavering support whenever needed. Our commitment to service excellence is evident through the following initiatives.

Dedicated technical support

We understand the importance of timely solutions. Our team is committed to responding to any technical queries within the shortest time, ensuring that you receive prompt and reliable assistance.

Transparent inspection policy

Transparency is at the core of our business values. Customers are always welcome to visit our facility for inspections as required.

Efficient & deliveries

Our customer support team is ever ready to ensure seamless deliveries right to your doorstep. With just a call or email, our engineers will ensure your order is processed smoothly.

Buffer stock for uninterrupted supply

We maintained a well-managed buffer stock for most of the tubes and fittings, ensuring that you are never delayed to unexpected urgent requirements arising from project modifications or site conditions. Our buffer stock allows us to cater to your needs promptly and efficiently.

Customer education & factory tours

We believe in empowering our customers with knowledge. We offer educational sessions to enhance awareness of our processes, manufacturing methodologies, and product quality. Additionally, we welcome you to make informed decisions based on first hand insights.

ASME-BPE CERTIFICATE

The American Society of Mechanical Engineers



CERTIFICATE OF AUTHORIZATION

The named company is authorized by The American Society of Mechanical Engineers (ASME) for the scope shown below in accordance with the applicable rules of the ASME BPE Standard on Bioprocessing Equipment. The use of the ASME Single Certification Mark and the authority granted by this Certificate of Authorization are subject to the provisions of the agreement set forth in the application. Any component certified under this authorization shall have been produced, assembled, and tested in accordance with the provisions of the ASME BPE Standard on Bioprocessing Equipment.

COMPANY:

Rahul Ferromet & Engineering Pvt Ltd
 Plot No 13 and 14
 Jhagadia GIDC
 Bharuch 393110
 India

SCOPE:

Manufacturer of ferrous tubing (excluding circumferential welds) and fittings at the above location only

AUTHORIZED: **May 03, 2023**
 EXPIRES: **May 03, 2028**
 CERTIFICATE NUMBER: **BPE-183**

Rahul B. Chaudhary
 Board Chair, Conformity Assessment

GM Eisenberg
 Managing Director, Standards & Engineering Services





www.rensatubes.com



Rahul Ferromet & Engineering Pvt.Ltd.

Head Office: 609, Sanket Heights,
Vadodara-390020, Gujarat, India

+91-8347 000 368

marketing@rensatubes.com

Plot No.13 & 14, Jhagadia GIDC,
Bharuch, 393110, Gujarat, India

